

Installation Instructions

Parts List

1. Left/Right End Cap
2. Aluminum Retainer
3. Outside Corner Assembly
4. Vinyl Cover
5. Impact Absorber

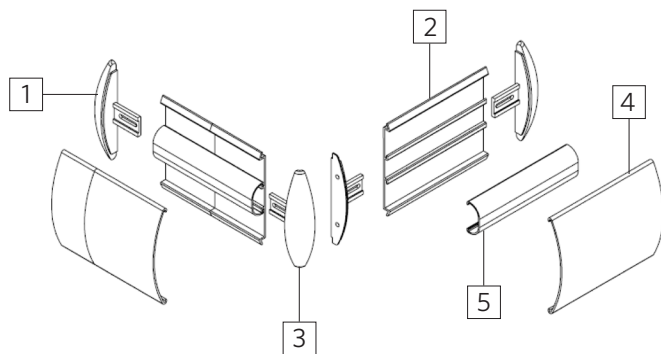

Pre-Installation Notes

When splices occur (runs over 12'-0"), always splice the aluminum retainers and the vinyl covers at different locations along the run. The minimum required spacing between the splice locations is 1'-0". The factory recommends using back up channels at stud wall conditions. If the material is being cut from stock lengths, cut the longest pieces first, then cut the shorter pieces.

Installation Steps

STEP 1

Using the correct plans and layout guides, determine the location of the top of the wall guard. Using a chalk line, snap a line along the wall $\frac{1}{8}$ " below the desired height to locate the top of the aluminum retainer (See **FIGURE 1**).

STEP 2

Once the wall guard is laid out, mark any required cuts to

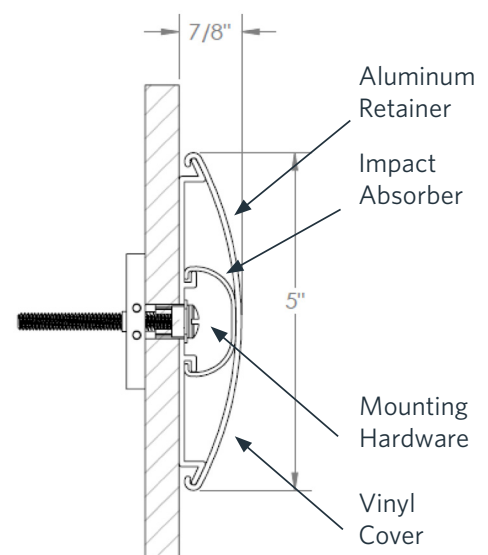

each aluminum retainer and cut to correct length. See **CUTTING ADJUSTMENT AND SCHEDULE** for adjustments to the aluminum retainer length that are required for end caps, inside corners, and outside corners. Refer to **MINIMUM LAYOUT CONFIGURATIONS** for additional information concerning spacing and minimum wall guard length requirements. For any corners that are not 90° the aluminum retainer should be miter cut to accommodate the corner. Note: All cuts must be square and deburred.

STEP 3

Select a section of the aluminum retainer. Mark the locations for the anchor holes on the retainer, centering the anchor holes along the center channel of the retainer. Anchors are spaced 16" O.C. MAXIMUM with an anchor a maximum of 3" from the end of the retainer. Drill the anchor holes through the retainer at the marked locations. Repeat this step for each retainer. If necessary adjust spacing to accommodate studs. Use a #15 (.180") drill bit for #8 fasteners, or a #7 (.201") bit for #10 and 3/16" fasteners. Note: Drill point fasteners may be used without pre-drilling the aluminum retainers on drywall installations having a continuous metal backing channel or studs. Note: Observe all safety precautions when drilling to avoid all utilities and re-bar.

STEP 4

Begin installation of the aluminum retainers at corners allowing for the molded accessories. Use the appropriate accessory as a spacing template. See **CUTTING ADJUSTMENT DIAGRAMS AND SCHEDULE** for additional information. To install the aluminum retainer, align the top of the retainer with the chalk line on the wall and fasten the retainer to the wall using the hardware listed below.

Drywall Installation: Fasten aluminum retainer to the wall using hardware listed below. If it is necessary to install fasteners in locations where there is no backing channel or stud, use the pre-drilled aluminum as a template to mark and drill the wall for Toggler® brand toggle bolts or plastic Alligator® inserts in accordance with the instructions provided with the hardware.

Masonry Installation: Using the pre-drilled aluminum retainer as a template, mark and drill the wall to accept plastic Alligator® inserts or for 3/16" Tapcon® or similar fastener. Drill the holes in accordance with the instructions provided with the hardware.

Suggested Hardware:

Drywall with metal backing channel	Drywall without a stud or backing channel	Masonry
#8 or #10 drill point drywall screw or #8 or #10 drill point pan head or hex washer head sheet metal screw	Plastic Alligator® insert with a #8 or #10 pan head or hex washer head sheet metal screw or a 3/16" Toggler® brand toggle bolt with a pan head machine screw	Plastic Alligator® insert with a #8 or #10 pan head or hex washer head sheet metal screw or a 3/16" hex head Tapcon®

STEP 5

Install end caps and outside corners as required. Use a flat washer at the molded components mounting tabs to prevent damage to the molded part caused by excessive tightening of the fastener (See **FIGURE 2**). Then cut (if required) and place the impact bumper to the center of the aluminum retainer and snap into place (see **FIGURE 3**). Note: The impact bumpers should be 1" short of the end of the retainer on both sides to allow for the end caps and corners to fit properly.



► 5" Crescent Wall Guard

STEP 6

Measure between the molded accessories, cut the vinyl cover accordingly. Miter cut the vinyl cover for all angles not accommodated by the molded accessories. All cuts must be square and deburred.

STEP 7

Place the vinyl cover along the bottom of the appropriate aluminum retainer, pushing upwards along the length of the cover. Snap it into place on the aluminum retainer (see **FIGURE 4**).

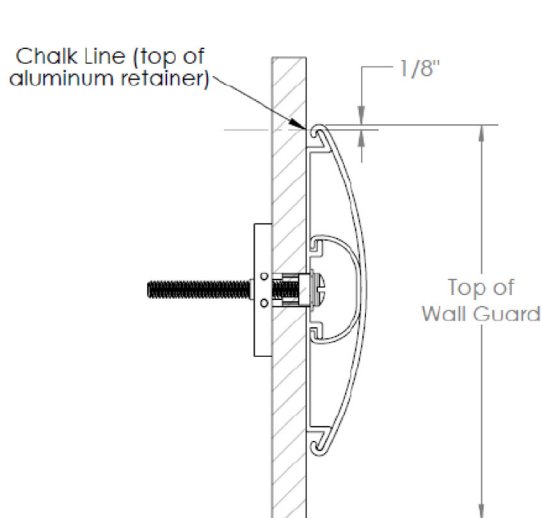

FIGURE 1

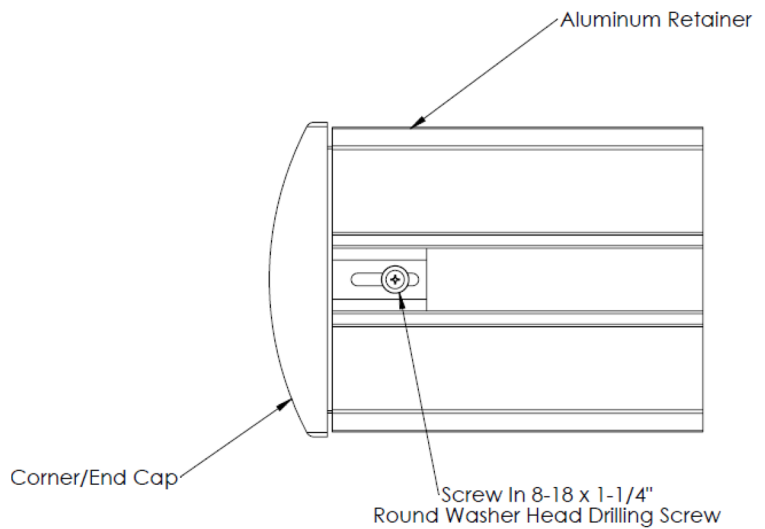

FIGURE 2

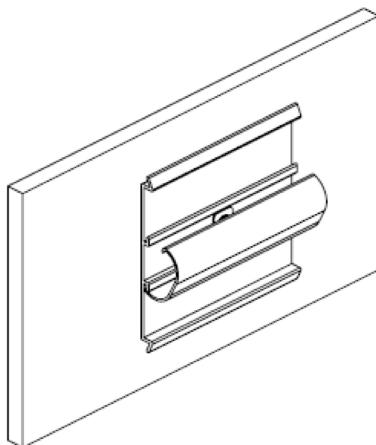

FIGURE 3

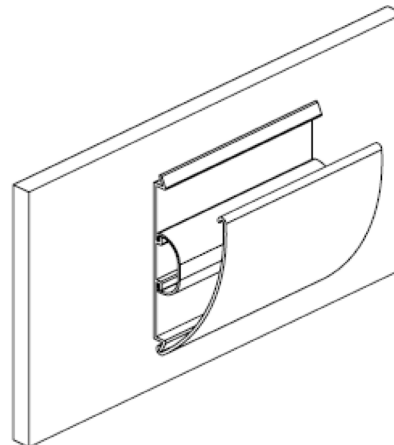
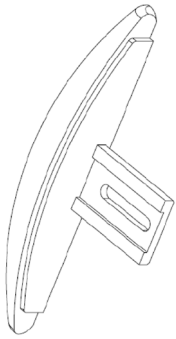
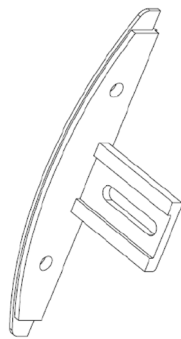

FIGURE 4





END CAP



CORNER ADAPTER

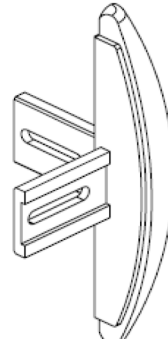

OUTSIDE CORNER

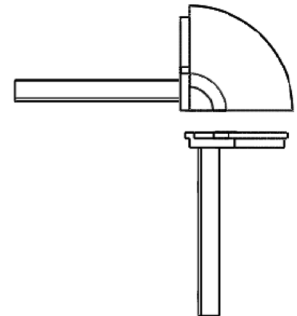

OUTSIDE CORNER ASSEMBLY

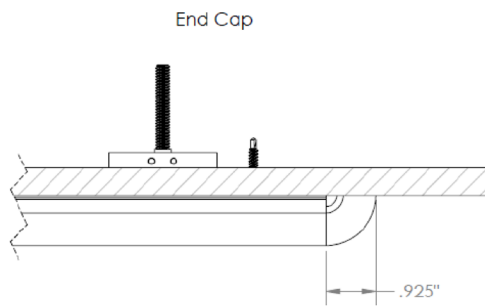

END CAP

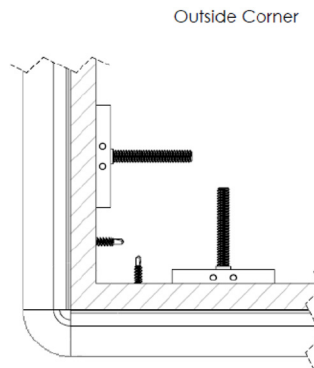

OUTSIDE CORNER

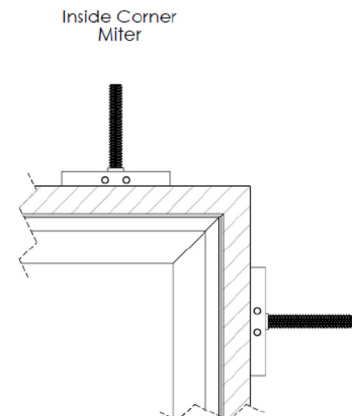

INSIDE CORNER

CORNERING AND END CONDITION DIAGRAMS

Important: Install aluminum retainer and molded accessories before cutting the vinyl snap-on cover.

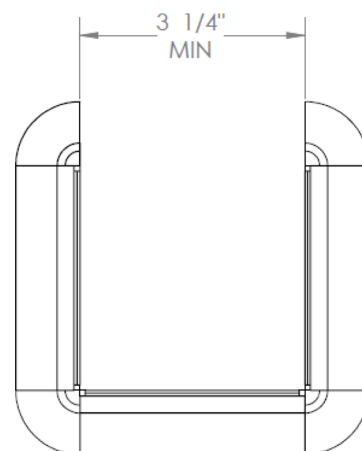
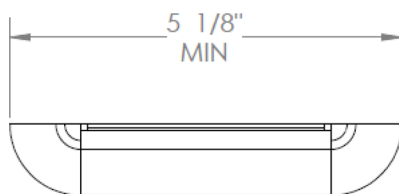

MINIMUM LAYOUT CONFIGURATIONS



Cutting Wall Guard

Stock Length material does not always have squared ends and may require squaring in the field. If space is available use a minimum 12' long cutting bench to allow the installer to cut the material without having to turn it around.



Storage & Handling

The wall guards are shipped unassembled. Upon receipt, the vinyl covers should be stored in a horizontal position at room temperature (65 - 75° F). This is a finished product; store in a protected, clean, dry area away from direct sunlight.



Cleaning Instructions

STEP 1

For best results, the use of liquid cleaners such as "409," "Fantastic," and "Mr. Clean," etc. are recommended. The use of powder cleansers is not recommended. Use of such cleansers can leave residue which is difficult to remove.

STEP 2

Do not use chlorinated or aromatic hydrocarbons, esters, or ketones to clean Wallprotex vinyl products. Avoid the use of heavy degreasers, compounds containing surfactants, and abrasive compounds or cleaning devices.



Caution

DO NOT walk on the wall guard.

DO NOT store anything on top of the wall guard.

