

SITE PLAN

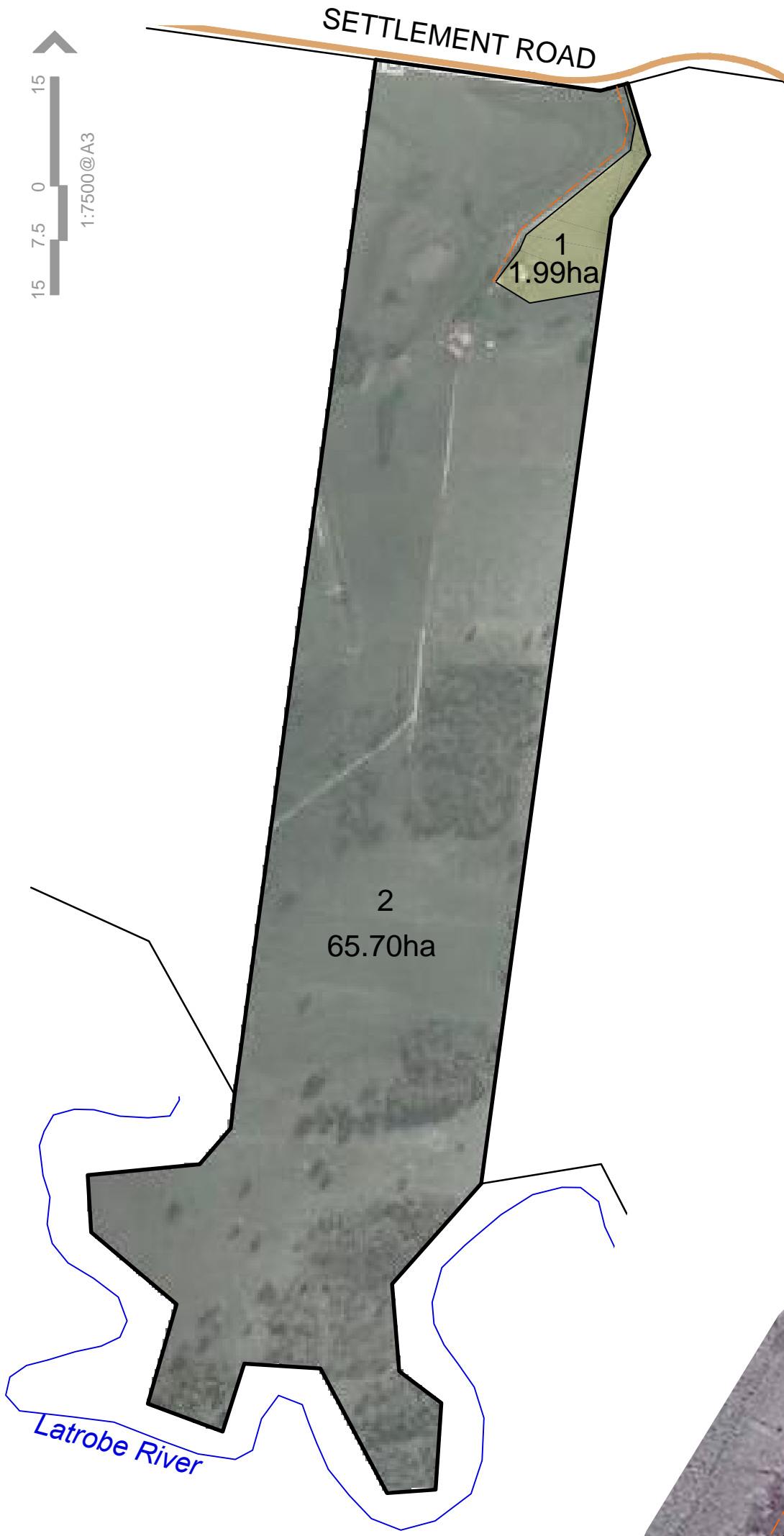

LOT 1 INSET



DIMENSIONS HEREON ARE SUBJECT TO SURVEY.
 THIS PLAN IS SUBJECT TO THE APPROVAL OF VARIOUS
 STATUTORY AUTHORITIES.
 PROPERTY BOUNDARIES ARE DERIVED FROM VICMAP DATA
 AND ARE SUBJECT TO SURVEY.

To Be Approved Millar & Merrigan and the NBA Group authorise the use of this drawing only for the purpose described by the status stamp shown hereon. This drawing should be read in conjunction with all relevant contracts, specifications, reports and drawings. © Millar & Merrigan Pty. Ltd. and the NBA Group.

PROPOSED SUBDIVISION PLAN

Allot. 6 Sec. B Parish of Wurruk Wurruk
 596 Settlement Road, Kilmany
 Wellington Shire

17606T1_V1
 Date : Mar 2014



NBAgroup

Millar & Merrigan Pty Ltd ACN 005 541 668
Metro 2/126 Merrindale Drive, Croydon 3136
Regional 156 Commercial Road, Morwell 3840
Mail PO Box 247 Croydon, Victoria 3136
T (03) 8720 9500 **F** (03) 8720 9501
Ausdoc DX 13608 Croydon
 admin@millarmerrigan.com.au
 millarmerrigan.com.au

NBA Group Pty Ltd ABN 194 748 327 43
Metro Level 1, 1 Queens Road, Melbourne, 3004
Regional 382 Raymond Street, Sale, 3850
Mail 156 Commercial Road, Morwell 3840
M 0418 402 240 **T** (03) 5143 0340
F (03) 5143 1244
 nick@nbagroup.com.au
 nbagroup.com.au