

A.M.G.  
ZONE 55

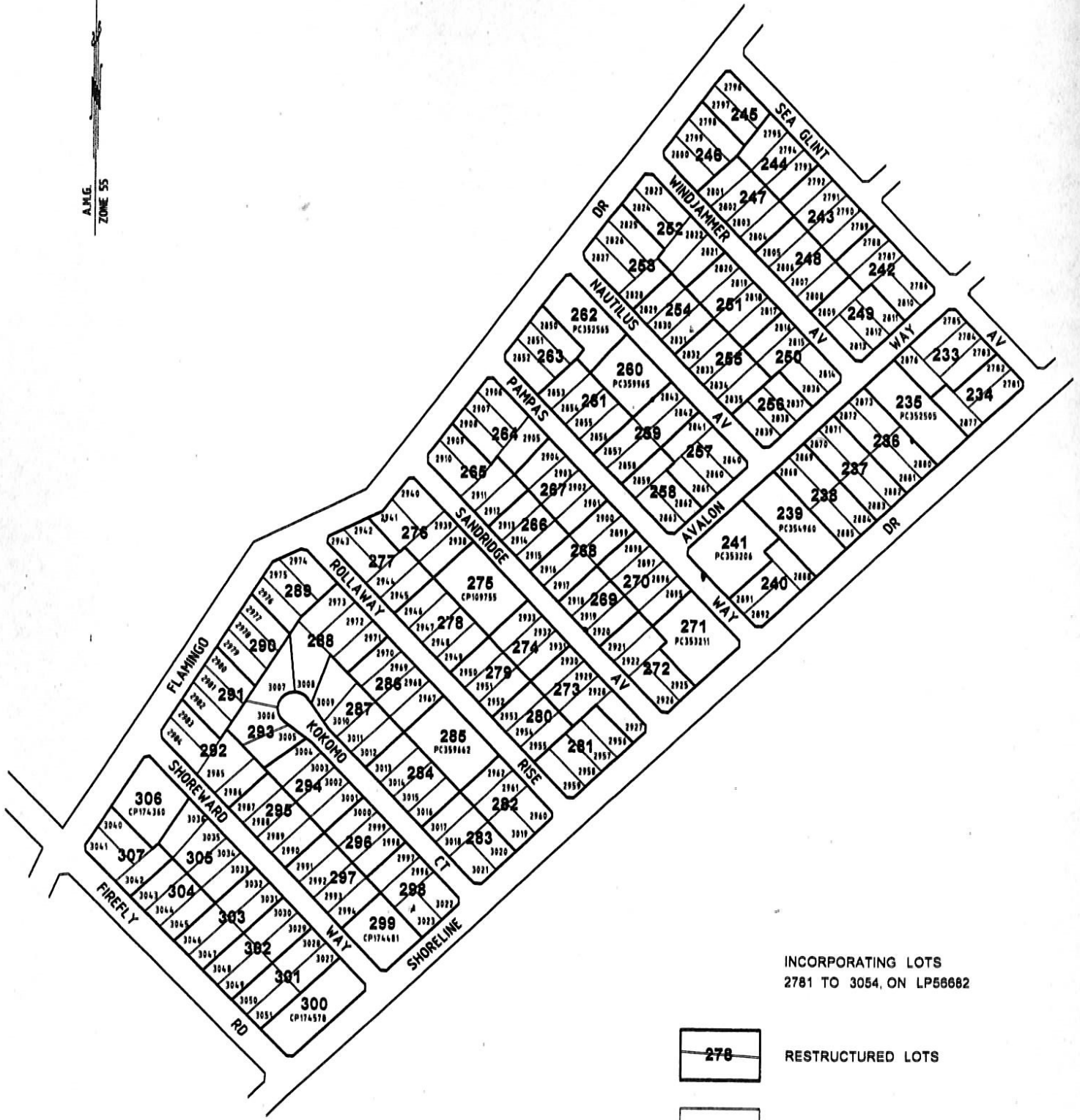

INCORPORATING LOTS  
2781 TO 3054, ON LP56682

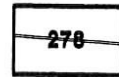

RESTRUCTURED LOTS

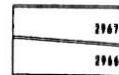

LOTS AS ON LP56682



HOUSE

# WELLINGTON PLANNING SCHEME - LOCAL PROVISION

**Fisher Stewart**  
 ENGINEERS - SURVEYORS - TOWN PLANNERS  
 ENVIRONMENTAL CONSULTANTS

**WELLINGTON SHIRE COUNCIL**

THE WELLINGTON SHIRE COUNCIL HAS THE HONOUR TO ADVISE YOU THAT THE LOCAL PROVISIONS OF THE WELLINGTON PLANNING SCHEME - LOCAL PROVISION, 1992, AS AMENDED, ARE NOW IN FORCE. THESE PROVISIONS WILL APPLY TO ALL LAND IN THE WELLINGTON SHIRE FROM THE DATE OF COMMENCEMENT OF THE SCHEME, UNLESS OTHERWISE PROVIDED IN THE SCHEME. THE SCHEME IS AVAILABLE FOR INSPECTION AT THE OFFICES OF THE WELLINGTON SHIRE COUNCIL, 100 RANGIPOA ROAD, WELLINGTON, DURING BUSINESS HOURS. IF YOU HAVE ANY QUESTIONS CONCERNING THE SCHEME, PLEASE CONTACT THE PLANNING DEPARTMENT ON (04) 489 8000.

*Reproduced from Gazette*

SCALE 1:3000

METRES  
 AUSTRALIAN MAP GRID ZONE 55

**NINETY MILE BEACH  
 RESTRUCTURE PLAN  
 STAGE R6**