

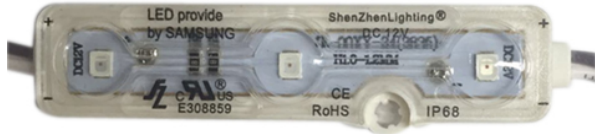

JS LED[®]

ECO Lighting Technology and Solutions



LED Module

Model No. JE-001R-24

Dimension

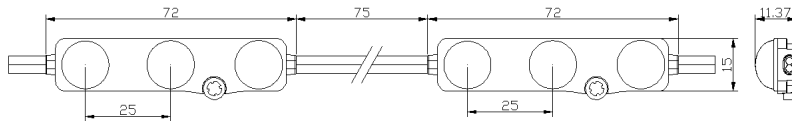

- Length..... 72mm
- Width 15mm
- Height 11.3mm
- LEDs per module..... 3
- Modules per foot..... 2
- Packagaing..... 50pcs x 2 rolls =100 Module per bag
24.36 Feet x 2rolls = 48.72feet

Specification

Model No.	JE-001R-24
Color	Red
LED Size	2835
Protection	IP68
Viewing Angle	120° ±5
Foward Voltage	12V
Foward Current	60mA
Wavelength	623nm
Luminous flux	16LM
Power consumption	0.72W
Operating Temperature	-25°C to 70°C

Electrical / Optical characteristics at TA=25°C

- *1. All dimensions are in millimeters.
- 2. Tolerance is ±0.25 unless otherwise noted.
- 3. Lead spacing is measured where the lead emerge package.
- 4. Specifications are subject to change without notice.

Please visit jsledpower.com for more information

For support please call toll free number 1-800-909-5188

Headquarter Office

1318 Maine Ave.,
Baldwin Park, CA 91706
Tel: (626) 338 - 8291
Fax: (626) 338 - 8391

Texas Branch

2307 Shaver St.,
Pasadena, TX 77502
Tel: (832) 270 - 1556

New Jersey Branch

600 Deer Rd., Suite #3
Cherry Hill, NJ 08034
Tel: (646) 287 - 5979

Florida Branch

4333 Silver Star Rd., Suite #170
Orlando, FL 32808
Tel: (407) 808 - 9768