

NEP EUROPA: FACTSHEET

NEP BELGIUM STUDIO 1

NEP Belgium
Nijverheidsstraat 17
1830 Londerzeel, Belgium

be.sales@nepgroup.com
+32 (0) 16 23 27 52



NEPGROUP.COM



SPECIFICATIONS

NEP BELGIUM STUDIO 1

- 1341 m²
- Perfect location for TV, film, commercial use and events
- Near the A12 highway from Brussels to Antwerp - we are very accessible and easy to access
- Equipped with 6 grid frames that can go up and down separately; each frame can lift up to 6800kg
- Power supply of 600kVA
- Greenkey wall of 18 W by 7 H, seamlessly connected to the floor
- Black curtains that cover the entire studio and a 60m seamless white cyclorama
- Equipped with a 60m bluekey curtain
- Includes its own technical room where clients can put dimmer racks and connect to several supply lines that go to the grids and lighting booms in the studio
- Connected to our warehouse, so sets and equipment can be loaded and unloaded inside the building, with direct access to the studio
- All accesses to the studios are at level 0
- Parking space for 2 OB trucks in warehouse, if needed
- 7 dressing rooms, plus a makeup and wardrobe room
- An office
- Reception on first floor to collect an audience

FLOORPLAN

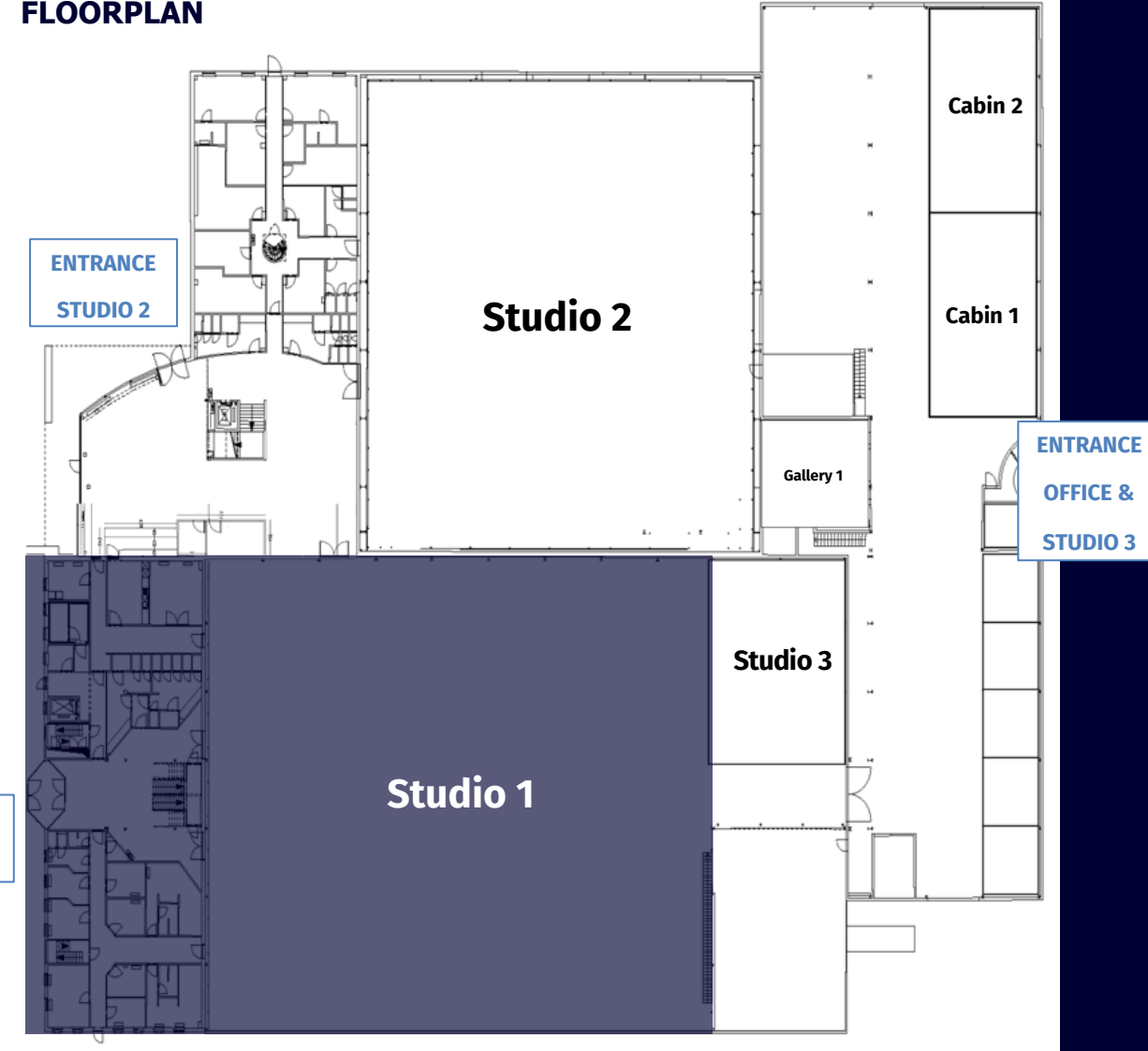

SPECIFICATIONS

NEP BELGIUM STUDIO 1

Large equipped studio: ideal for TV productions, Film & Corporate Events

Studio Floor	Total Floor Area	45,20m (L) x 34,60m (W) = 1564m2
	Free Floor Area	42,30m (L) x 31,70m (W) = 1341m2 (inside cyclo)
	Height Under Catwalks	7,70m
	Height Under Grid	7,95m (max. height)
	Height Under Rigging Beams	9,80m
		Studio can be divided in 2 areas
	Floor Type	Polybeton (Epoxy)
Grid	General	Greenkey wall of 18 W by 7 H, seamlessly connected to the floor
		3 grid frame with dimensions 19m x 9,60m
		3 grid frame with dimensions 18m x 9,60m
		Each grid frame is equipped with 7 Harting 16 plugs with 5 channels, connected with Harting connectors in the dimmer room.
Power Supply		Total of 600 kVA/ 3 x 380 + N, subdivided into: Number – Amperes/phase – Connector – Location
		1 x 250 A Powerlock Studio
		1 x 125 A CEE Studio
		1 x 63 A CEE Studio
		2 x 4 32 A (25A) CEE Studio
		4 x 250 A Powerlock Dimmer Room
Acces	Emergency Doors	1 x 2,31m (W) Double emergency doors
		1 x 1,92m (W) Double emergency doors
		1 x 0,90m (W) Single emergency doors
	Studio Acces	From storage to studio: 4 m (W) x 4,78 m (H)
		From street to studio: 4 m (W) x 4,78 m (H)
		From Studio to dressing rooms: 0,89 m (W) x 1,98m (H)
		Loading platform height relative to ground: 0 m



SPECIFICATIONS

NEP BELGIUM STUDIO 1

Large equipped studio: ideal for TV productions, Film & Corporate Events

Curtains	Black	Covers the entire studio
	Neutral light Grey Cyclorama	60m
	Bluekey	60m
	Greenkey	
	Cyclorama system circuits on rails	The entire studio
		Half the studio on the left
		Half the studio on the right
		All curtains are fireproof
Building Facilities	Dressing Rooms	6 units (Average area 8 m2) Mirror, Dresser, Chair
	Luxury Dressing Rooms	1 units (16 m2 + 6 m2) Mirror, Dresser, Chair, washbasin + Separate shower
	Makeup Room	17 m2 Mirrors with lighting, Work surface, Washbasin with hot and cold water
	Wardrobe Room	20m2 Washing machine + Dryer
	Production Room	21m2 Additional rooms on request
Light Setup	Console	N/A
	Softlight	N/A
	Keylights	N/A
	Effect Lights	N/A

