

47" Dipping Cabinet - 12 Tub Capacity

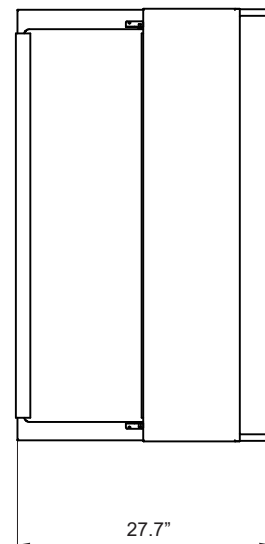

- External dimensions (WDH) 47.2" x 27" x 51.3"
- Interior dimensions (WDH) 41.2" x 21.9" x 28.9"
- White-painted steel exterior
- Holds 8 cans in the display
- Holds 4 cans in storage
- LED interior lighting
- Temperature range -23° to -15° Celsius (-9.4° to 5° Fahrenheit)
- Digital controls
- Environmentally-friendly R290 refrigerant
- 2 year parts and labour warranty. 5 year warranty on the compressor parts.

Model	Refrigerant	Electrical	Plug	Storage	Interior Dimensions	Exterior Dimensions	Net Weight	Shipping Dimensions	Shipping Weight
iBC-DPC47	R290	115v/60hz/4.8a /1ph	NEMA 5-15P	8 cans in display; 4 cans in storage	41.2"x21.9" x28.9"	47.2"x27"x51.3"	240 lb.	51"x32"x58"	346 lb.

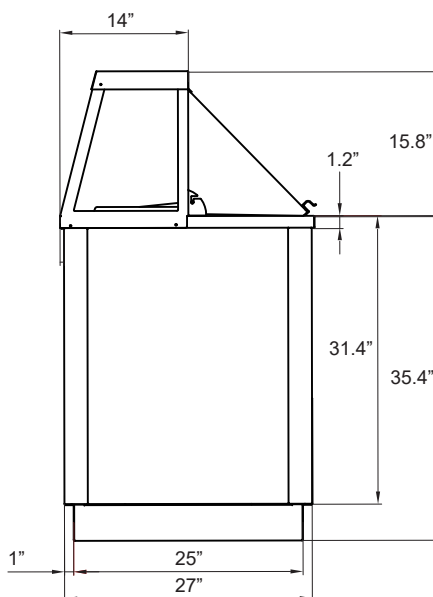
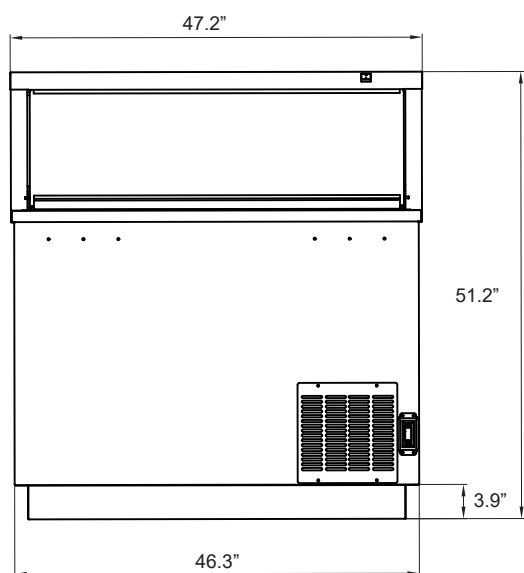

ETL Electrical Listed
USA & Canada



ETL Sanitation Listed



Environmentally-friendly
R290 Refrigerant



Natural Resources
Canada Approved

