



02 Series



08 Series



Blister

## NON - AUTOMATIC BILGE PUMPS 02/08 SERIES 350/600 GPH

### FEATURES & BENEFITS

- Pump and switch are stand alone products
- Compact, efficient, long life motors
- Size: 350, 600 gph in 12 volt version
- Easy clean snap-lock strainer bases
- Completely submersible
- Marine grade blocked wiring
- Quiet and vibrationless operation
- 18 AWG, 1 m long leads

### MOTOR

#### Type

Compact, efficient, long life motor

#### Temperature Limits

110 °F (43 °C) Max.

#### Duty Cycle

Intermittent

#### Voltage

12 V / 24 V

### 350GPH PERFORMANCE

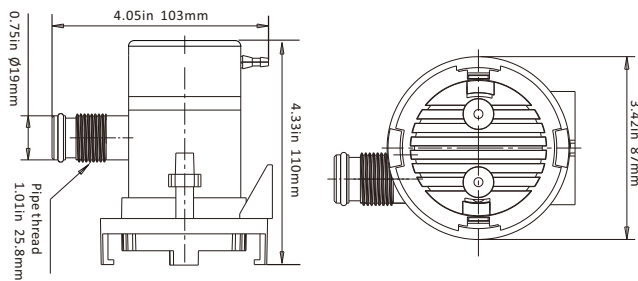
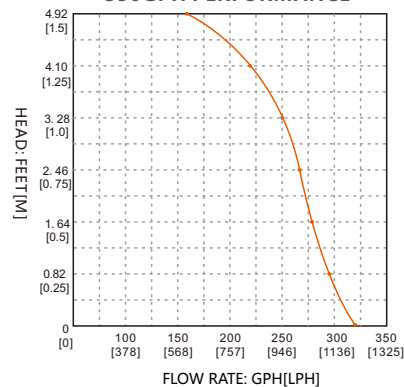

02 Series

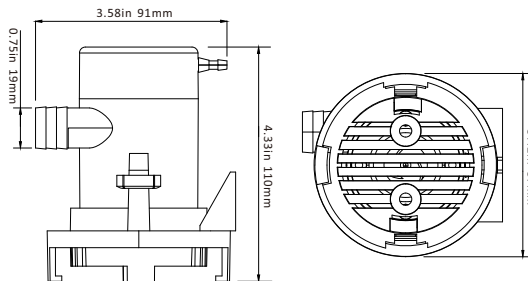

08 Series

### STANDARD PUMP CONFIGURATIONS

| Model         | Flowrate | Volts | Current | Head          | Wire lead | Outlet Dia.  | N.W./G.W.      |
|---------------|----------|-------|---------|---------------|-----------|--------------|----------------|
| SFBP1-G350-02 | 350 GPH  | 12V   | 1.0 A   | 3 m / 10'     | 1 m / 3'  | 19 mm / 3/4" | 0.33 / 0.40 kg |
| SFBP1-G600-02 | 600 GPH  | 12V   | 3.0 A   | 3.5 m / 11.5' | 1 m / 3'  | 19 mm / 3/4" | 0.33 / 0.40 kg |
| SFBP1-G350-08 | 350 GPH  | 12V   | 1.0 A   | 3 m / 10'     | 1 m / 3'  | 19 mm / 3/4" | 0.22 / 0.28 kg |
| SFBP1-G600-08 | 600 GPH  | 12V   | 3.0 A   | 3.5 m / 11.5' | 1 m / 3'  | 19 mm / 3/4" | 0.22 / 0.28 kg |