

# Grease Guardians GGX Range

## GREASE REMOVAL UNIT (UNDERSINK)



- Traps grease & foodwaste
- Removes grease automatically
- Reduces pump out requirements
- Robust stainless steel construction
- Easy to install and maintain
- Protects drains (point of source)
- Collected waste can be recycled
- Programmable digital controls
- Tested and approved internationally
- Self-cleaning options available
- Side mounted solids filter
- No need to open main lid
- No enzymes or bacteria dosing needed
- Extended warranty options



## THREE-STAGE OPERATION SYSTEM

### STAGE 1 Solids Collection

Wastewater from the kitchen is directed through the inlet of the **Grease Guardian®** where a removable strainer basket collects any solid debris.

### STAGE 2 Grease & Oil Separation

Grease in the wastewater floats to the surface and is trapped while the clear water leaves the unit and enters the drainage system.

### STAGE 3 Self Cleaning & Grease Removal

The timer-driven heating element is activated to liquefy grease, which is then removed by the skimming wheel and deposited into a portable container for recycling. Can be connected to: pot wash sinks, pre-rinse sinks, combi ovens, Chinese cookers and floor drains.

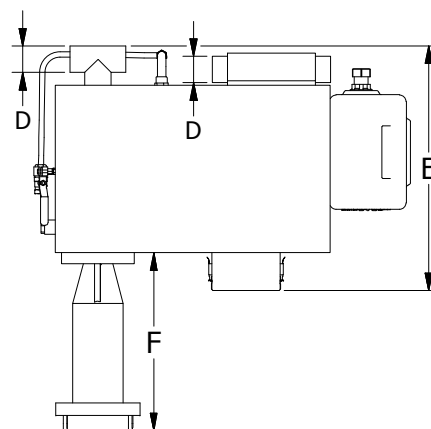
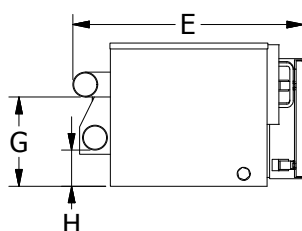
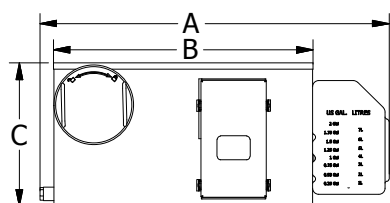

Model	Length (A) INCLUDES CONTAINER	Length (B) TANK ONLY	Height (C)	Inlet/Outlet (D)	Width (E) INCLUDES PANEL	Basket (F) CLEARANCE NEEDED	Inlet Height (G) INLET	Outlet Height (H) OUTLET	Max Flow
<b>GGX7(S)</b>	662	443	344/444	48	516	405	321	251	0.50 l/sec
<b>GGX15</b>	842	623	346	60	557	405	215	87	1.00 l/sec
<b>GGX25</b>	870	657	423	60	570	405	298	170	1.58 l/sec
<b>GGX35</b>	1092	873	422	89	577	405	281	170	2.21 l/sec

All dimensions in mm. Inlet / outlet height from the bottom of the pipe.  
Please note dimensions are subject to change without notice. Always request the latest drawings from your suppliers.

**Specification:** Automatic grease trap with inbuilt FOG treatment, FOG removal and self cleaning mechanisms. 16 Gauge 304 Stainless Steel with bright finish, 25 Watt, 230VAC; 50Hz Motor. 600-Watt Heater X7, X15, X25; 1000-Watt X35 Heater with Thermal Cut Out included. Logic Controller with Backlit Display. Skimming Drum is nominally capable of skimming 5 l per hour. Can be connected to pot wash sinks, pre-rinse sinks, combi ovens, Chinese cookers, floor drains and most grease producing kitchen appliances. UL, PDI, CSA, and ASME tested.



1300 556 628  
ecoguardians.com.au  
info@ecoguardians.com.au