

武汉历史之城背景下的 龟北片城市设计探讨

DISCUSSION ON THE URBAN DESIGN OF GUBEI AREA
UNDER THE BACKGROUND OF WUHAN HISTORICAL CITY

亢晶晶 Kang Jingjing

Wuhan Land Use and Urban Spatial Planning Research Center (WLSP)

2018年12月



/01

武汉整体概况

Wuhan Contents

武汉整体概况 | Wuhan Contents

武汉，又名“江城”，湖北省省会，中国中部地区的国家中心城市。

Wuhan, also known as "River City", is the capital of Hubei province and the National Central City in central China.



武汉整体概况 | Wuhan Contents

从地理区位来看，

武汉地处江汉平原，长江中游，是承东启西、接南转北的国家地理中心，自古就有“九省通衢”之称。

As a national geographic center of China, Wuhan is located in the middle reaches of the Yangtze River. And it has always been hailed as the “thoroughfare to nine provinces”.



武汉整体概况 | Wuhan Contents

从历史人文来看，武汉是国家历史文化名城、楚文化的重要发祥地。拥有丰富的历史文化资源。

As the birthplace of Chu Culture, Wuhan is also a famous city of history and culture with abundant historic and cultural resources.





武昌起义军政府旧址 | Site of Military Government of Wuchang Uprising

武汉整体概况 | Wuhan Contents

汉口
HAN KOU

Han River

汉阳
HAN YANG

Yangtze River

武昌
WU CHANG

从空间格局来看，世界第三大河流-长江及其最大支流汉江横贯市境中央，形成了两江交汇，三镇鼎立、龟蛇锁大江的山水人文意向，奠定了武汉拥有世界罕见的城市格局。

The Yangtze River and its largest tributary, the Han River, converges in Wuhan, and forming the urban pattern of three towns standing across the rivers, with Turtle Mountain and Snake Mountain on each side, which is rare in the world.

An aerial photograph of a city park at sunset. The park features a central river with several traditional Chinese pavilions with ornate, multi-tiered roofs. The river flows through the park, and the surrounding city is visible in the background. The sky is filled with soft, golden light from the setting sun. The foreground shows the edge of a large, traditional Chinese building with a tiled roof.

两江交汇，三镇鼎立、龟蛇锁大江的城市山水格局

**three towns standing across the rivers
with Turtle Mountain and Snake Mountain on each side**



/02

龟北片的重要地位及基本情况

Guibei Area Contents

龟北片的重要地位 | Significant of Guibei Area

地理区位的中心

THE CENTER LOCATION OF WUHAN

区域地理位置得天独厚，武汉三镇核心之地



龟北片

龟北片的重要地位 | Significant of Guibei Area

地理区位的中心

THE CENTER LOCATION OF WUHAN

区域地理位置得天独厚，武汉三镇核心之地



龟北片的重要地位 | Significant of Guibei Area

景观意向的核心

LANDSCAPE CORE AREA OF WUHAN

拥有两江一山一湖的自然生态景观资源，占武汉主城区的45%



世界第三大河流
长江

Yangtze River

长江第一
汉江
Han Ri



龟北片的重要地位 | Significant of Guibei Area

景观意向的核心

LANDSCAPE CORE AREA OF WUHAN

与长江南岸的蛇山遥相呼应，形成了“龟蛇锁大江”的核心城市意向



龟北片的重要地位 | Significant of Guibei Area

城市发展的起源

THE ORIGIN OF URBAN DEVELOPMENT OF WUHAN

武汉城市空间拓展以两江交汇的龟北片为原点，南北沿长江蓝轴，东西沿东西山脉绿轴向外不断向外延伸。

新石器时代-春秋时期



三国时期



唐宋时期



1949

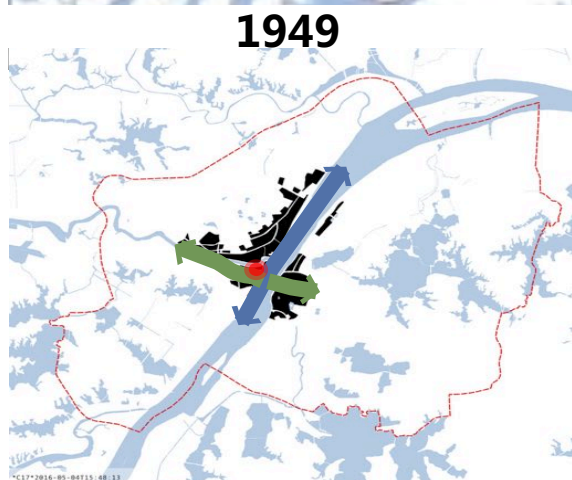

2000

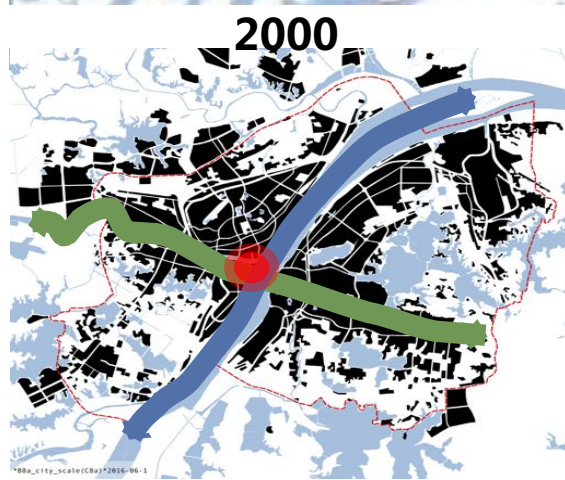

2013

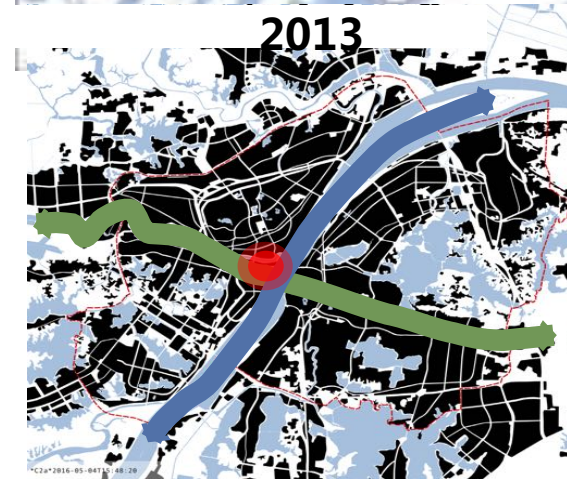

古琴台 | Guqin platform



吳橫江將軍魯肅之墓







武汉长江大桥 | Yangtze River Bridge



汉阳特种汽车制造厂 | Hanyang Special Automobile Factory

龟北片的重要地位 | Significant of Guibei Area

自98年特大洪水后，龟北地区的开发建设备受市委市政府和广大市民的密切关注。历经多轮国际规划征集和比选，市政府决定对该地区进行“留白性保护”。

Since the catastrophic floods in 1998, the development and construction of Guibei area has received close attention from the government and the public. After many rounds of international planning collections, government has decided to carry out "blank reserve" in the area.

历年方案总结：1998年 - 至今

2000年

- 龙王庙及南岸嘴地区综合整治规划
- 南岸嘴地区控制性详细规划
- 南岸嘴地区规划设计国际咨询和创意竞赛

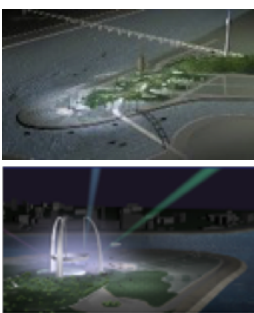

2003年

- 汉江两岸地区总体规划方案咨询国际征集



2004年

- 汉江两岸地区综合开发建设规划
- 南岸嘴及龟北地区建设策划
- 月湖文化主题公园规划及琴台文化艺术中心设计方案国际征集

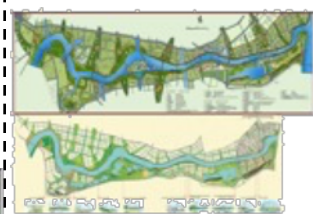

2006年

- 武汉龟山北地区城市设计

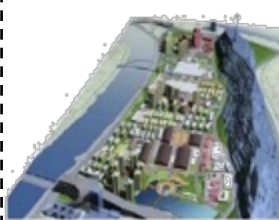

2008年

- 南岸嘴及龟北地区概念规划设计



2009年

- 多家境内外知名设计机构考察与访谈



2010年

- 南岸嘴及龟北地区功能定位前期策划研究



2014年

- 武汉市两江四岸旅游功能提升总体规划

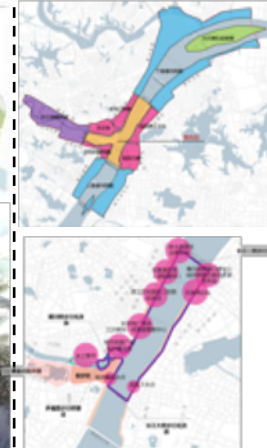

2016年

- 两江四岸起步区实施性规划





“留白性保护” 的龟北及南岸嘴
“Blank Reserve” in Guibei Area

龟北片现状概况 | Basic Situation of Guibei Area



Zhongshan Avenue

Chongren Road

Musheng Road

South Liji Road

Duofu Road

South Youyi Road

Yanjiang Road

The first Jianshan Bridge

Qingchuan Bridge

Han River

The second ring road

Qintai Avenue

Beijing-Guangzhou Railway

Yingwu Avenue

North Guishan Road

South Guishan Road

Yingwu Dyke

Yangtze River

Hanyang Avenue

Yangtze River Bridge

龟北片现状概况 | Basic Situation of Guibei Area

现状用地情况：现状用地包括南岸嘴江滩公园，龟山公园，汉阳造文创产业园（鹦鹉磁带厂）、特种汽车制造厂、国棉一厂等工业遗产，以及约65公顷的可开发用地等。

There are Nananzui Park, Turtle Mountain Park, three industry heritages , and about 65 hectares of exploitable land.

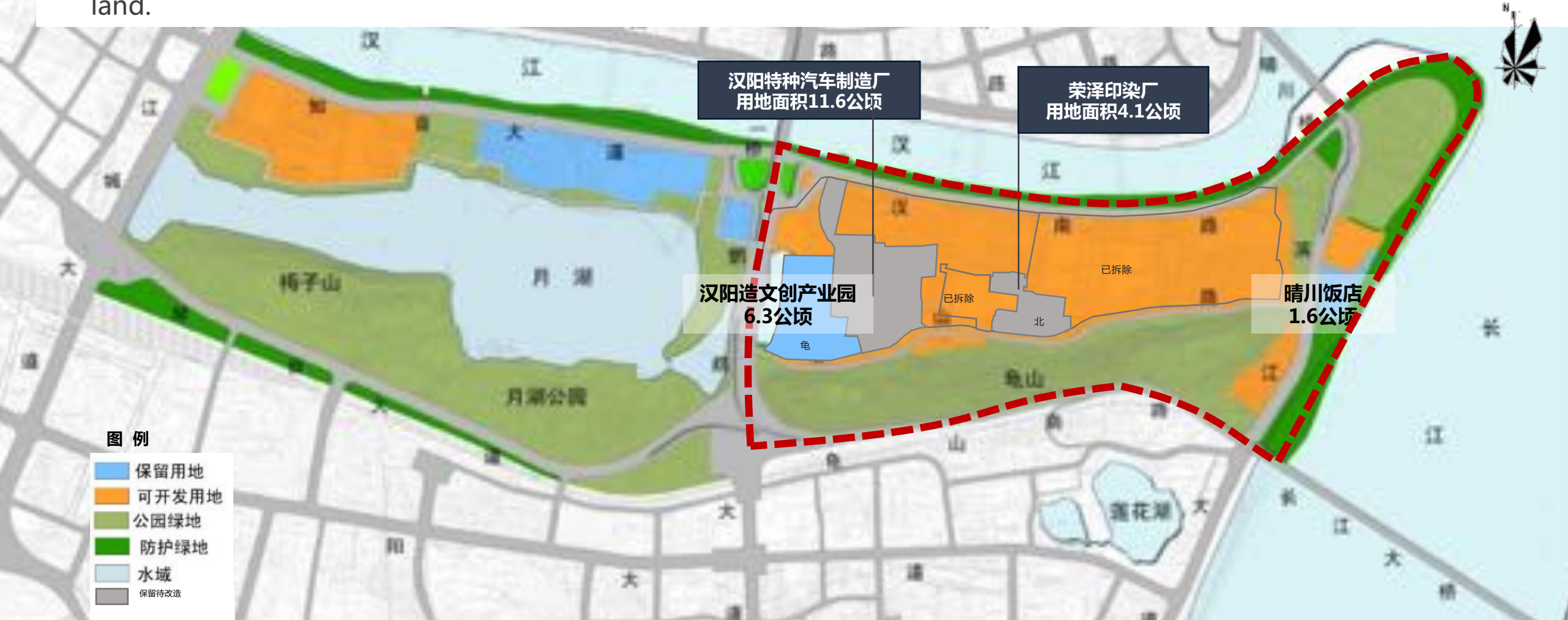

龟北片现状概况 | Basic Situation of Guibei Area

Three Key Issues: Inconvenient Transportation

城市设计需关注的重点问题：一是交通问题，该地区交通通而不达，一直处于“灯下黑”的困境。



龟北片现状概况 | Basic Situation of Guibei Area

Three Key Issues: Ineffective Utilization of Historical Resources

城市设计需关注的重点问题：资源利用问题，该地区历史人文资源缺乏有效地整合，未能得到有效利用。

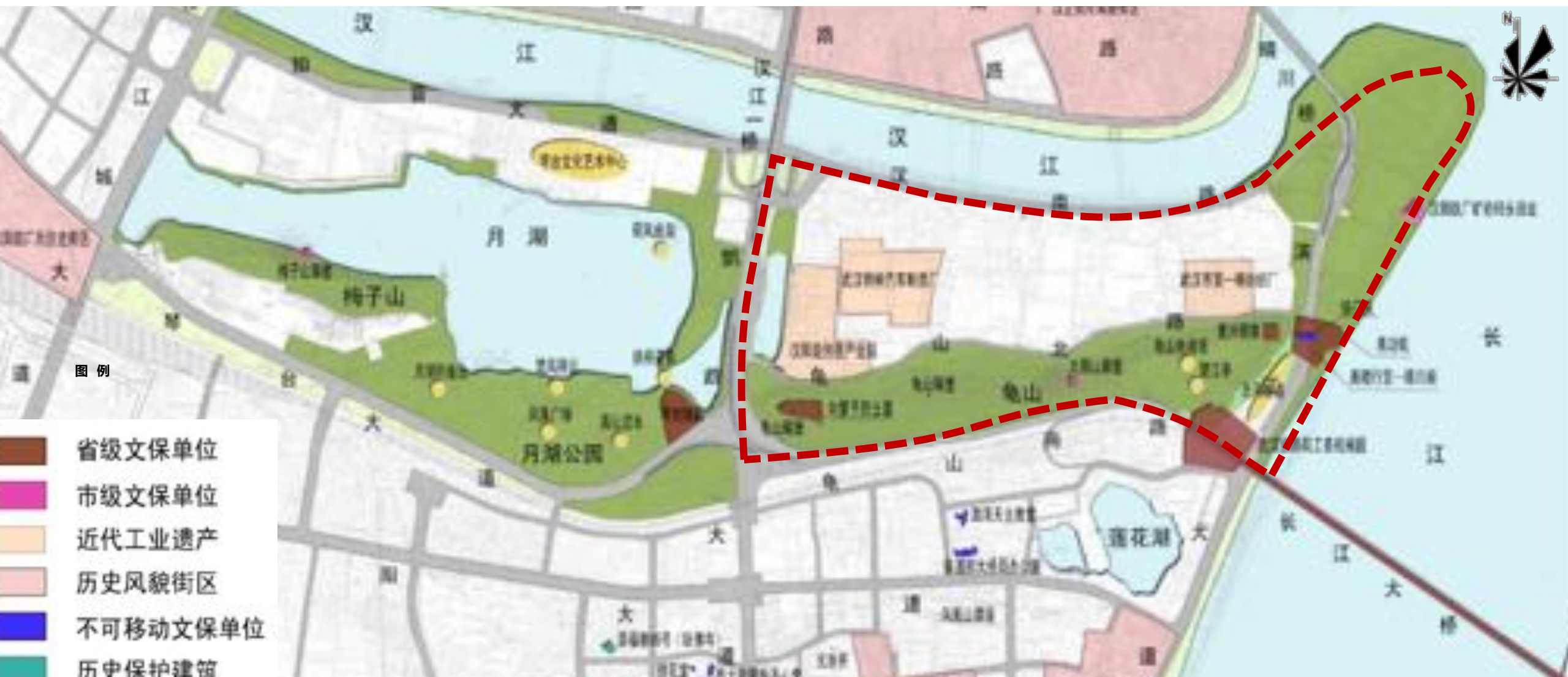

龟北片现状概况 | Basic Situation of Guibei Area

Three Key Issues: Inaccessibility of Waterfront Public Space

城市设计需关注的重点问题：滨水景观问题，该地区受到防洪等因素的影响，临水不见水。

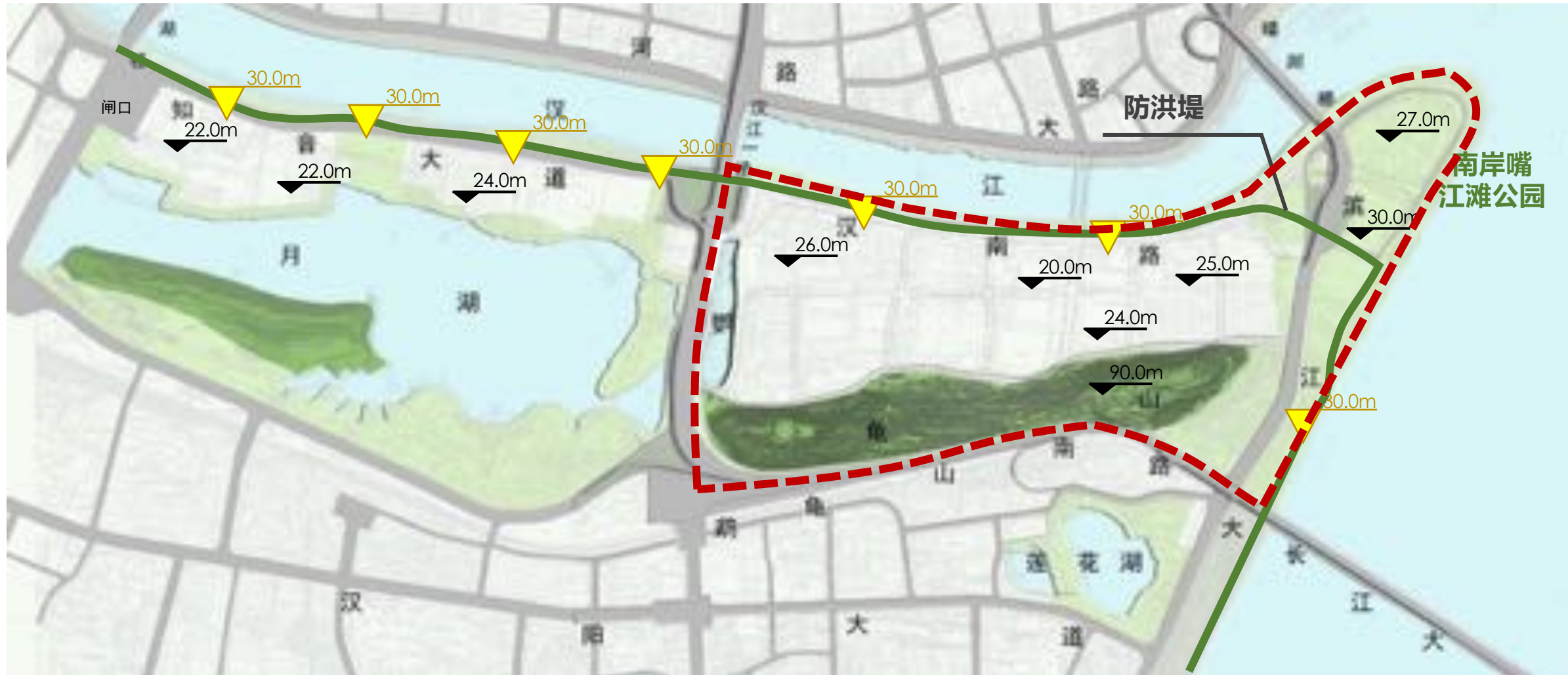



城市设计竞赛方案

Urban Design Student Competition Proposal

城市设计竞赛 | Urban Design Student Competition Proposal

今年5月，市国土规划局、市地空中心携手联合国人居署，围绕“**提高并缝合城市中心公共空间、复兴城市滨水空间、复兴工业遗迹、促进社会包容性及创新性城市旅游目的地**”四大主题，举办武汉历史之城（龟北片）国际学生城市设计竞赛。

In this May, WLPB, WLPS invited United Nations Human Settlements Programme to organize the International Student Urban Design Competition for this area.



城市设计竞赛 | Urban Design Student Competition Proposal

共收到来自全球数十个国家的学生作品，共计53份，其中境外32份。

A total of 53 student works have been received from dozens of countries around the world, of which 32 are from abroad.



城市设计竞赛 | Urban Design Student Competition Proposal

评审专家团队由联合国人居署专家、地空中心专家及历史之城项目组、高校教授共同组成。

Review expert team = UN-HABITAT + WLSP + Historic city Team + University Professor

等级	No.	Name of team leader	Designing Themes	Nationality	Countries of where the team is studying
3	155	Meher Afjun Faria		Bangladeshi	Bangladesh
	69	Mariam Kassem Bazzi		Lebanese	Lebanon
	148	Siti Anura Binti Che Nasir		Malaysian	Malaysia
	125	Tasnuva Zaman		Bangladeshi	Bangladesh
	119	Nikola Mitrovic		Serbian	Serbia
2	120	Md.Saiful Alam	Urban Heritage and Transformation	Bangladeshi	Bangladesh
	94	Daniel Janssen	From the heart of China to the centre of the world	Australian	Australia
	54	Huang Chi Ho	Cultural Furnace	China Hong Kong	China Hong Kong
	50	YANG Kun	Co-Existence City	Chinese	China
	49	YUAN Jingda	Xing Sheng	Chinese	China
	143	Gao Tongxi	Symbiosis with natural and cultural context	Chinese	China
	157	MA Xiaosong	Fluidity and Symbio	Chinese	China
1	151	Muhammad Syahmi Bin Sallehudin	Creative Industrial Park	Malaysian	Malaysia
	12	LIU Ruoshui	Wuhan' s Wilder Heart	Chinese	USA
	107	WANG Fujing	Breathing Link	Chinese	China

01 城市呼吸带 | Urban Breathing Link



The design scope of this scheme is from the foot of Guishan Mountain in Hanyang, east of Yangtze Avenue to the south bank mouth, with a total planning area of 167 hectares. This project intends to construct a public activity axis system in Guibei District, in order to integrate the abundant natural resources and cultural resources such as Qintai Cultural Center, Wudang Park, Guishan, Nan anzui, Qingchuan Pavilion, Yangtze River, forming a complete urban belt and constructing a new city center and city card of Wuhan.

In combination with the status quo of the base, fully tapping the existing foundation, we divided the public activity zone into different areas, giving different meanings. From West to east, it is the commercial transportation complex, creative cultural industry leisure belt, individual area transformation large-scale public activity belt, Hanyang folk custom

01 城市呼吸带 | Urban Breathing Link

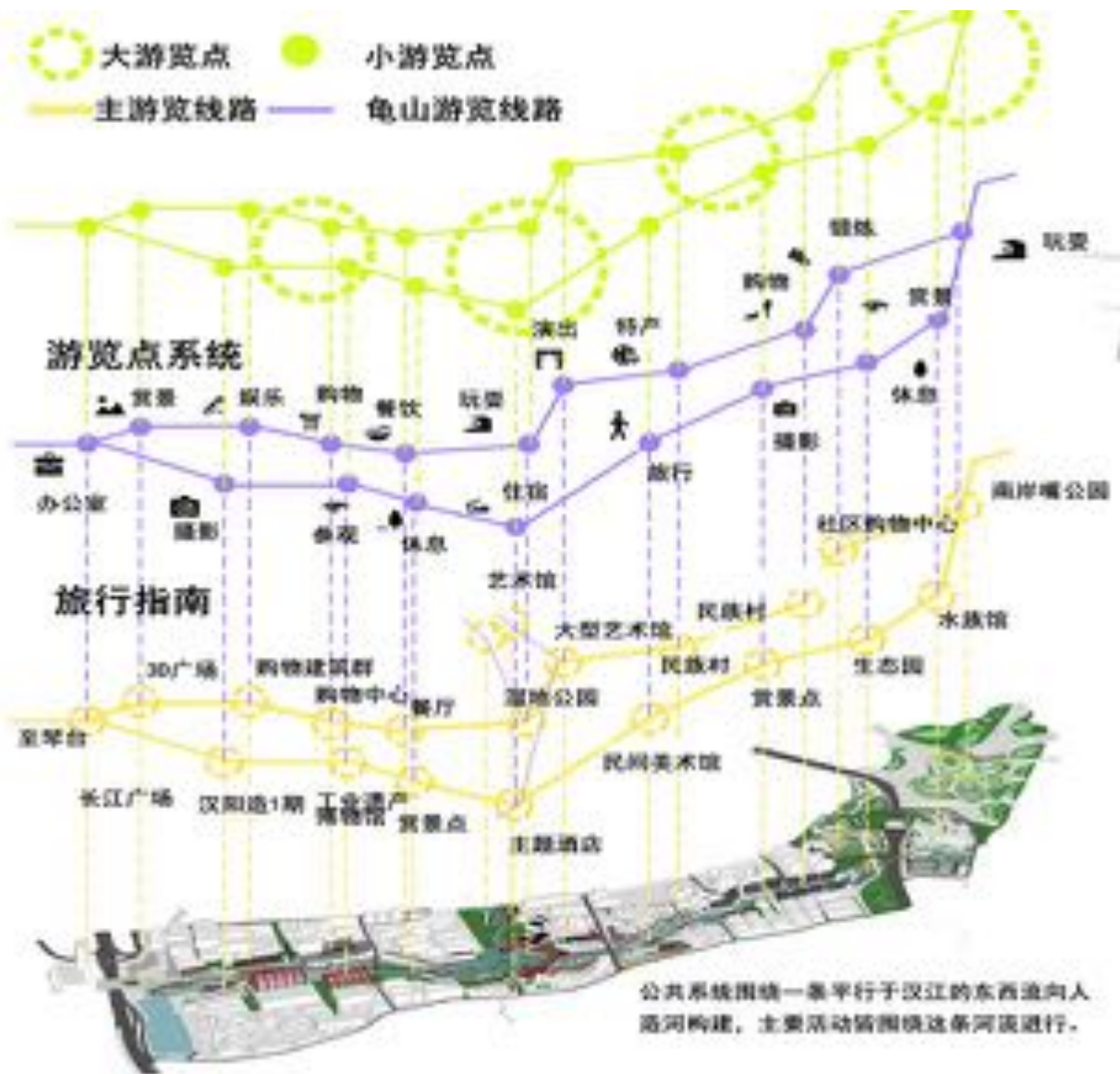

空间分级系统

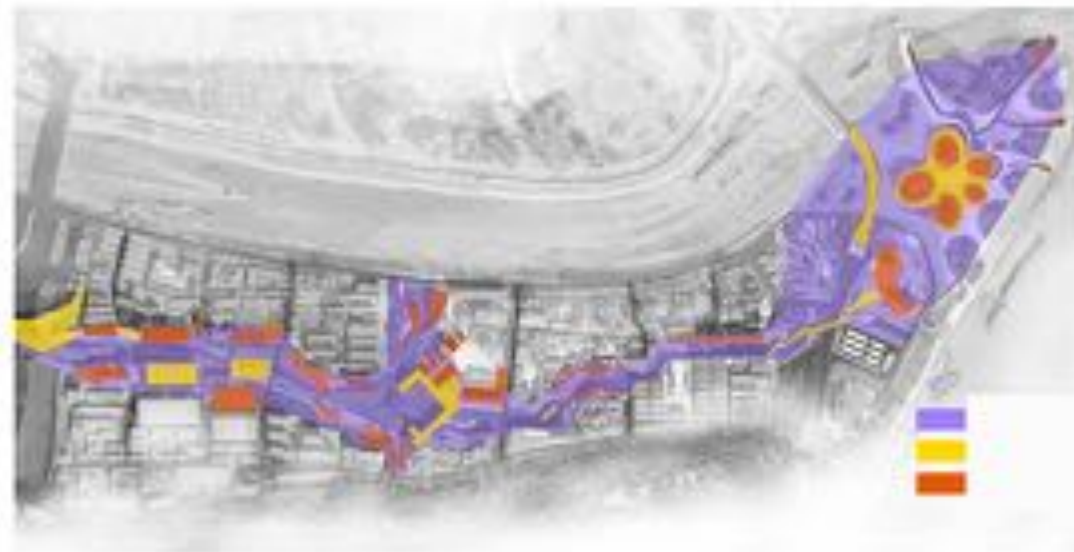

空间排序系统

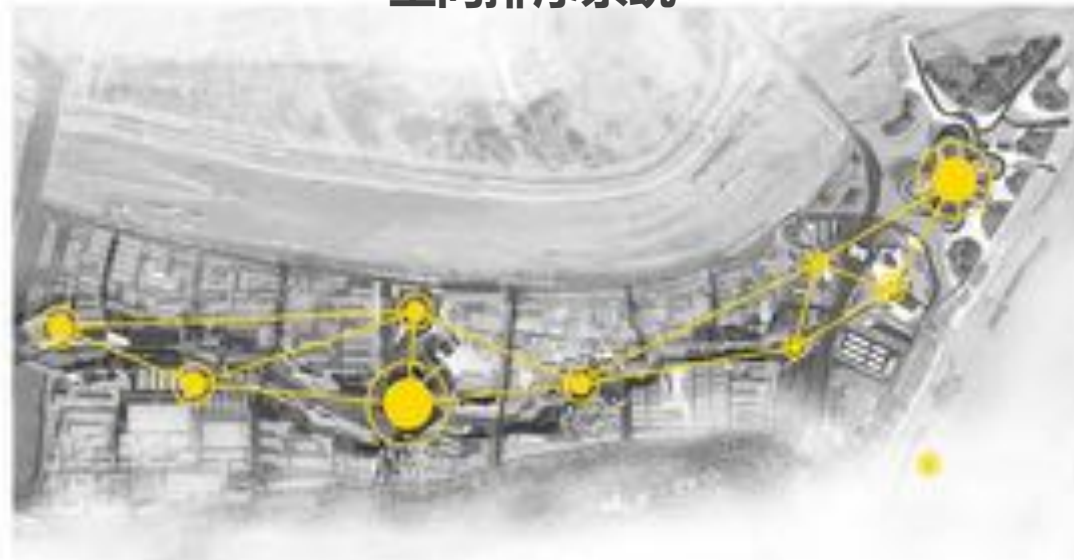

01 城市呼吸带 | Urban Breathing Link

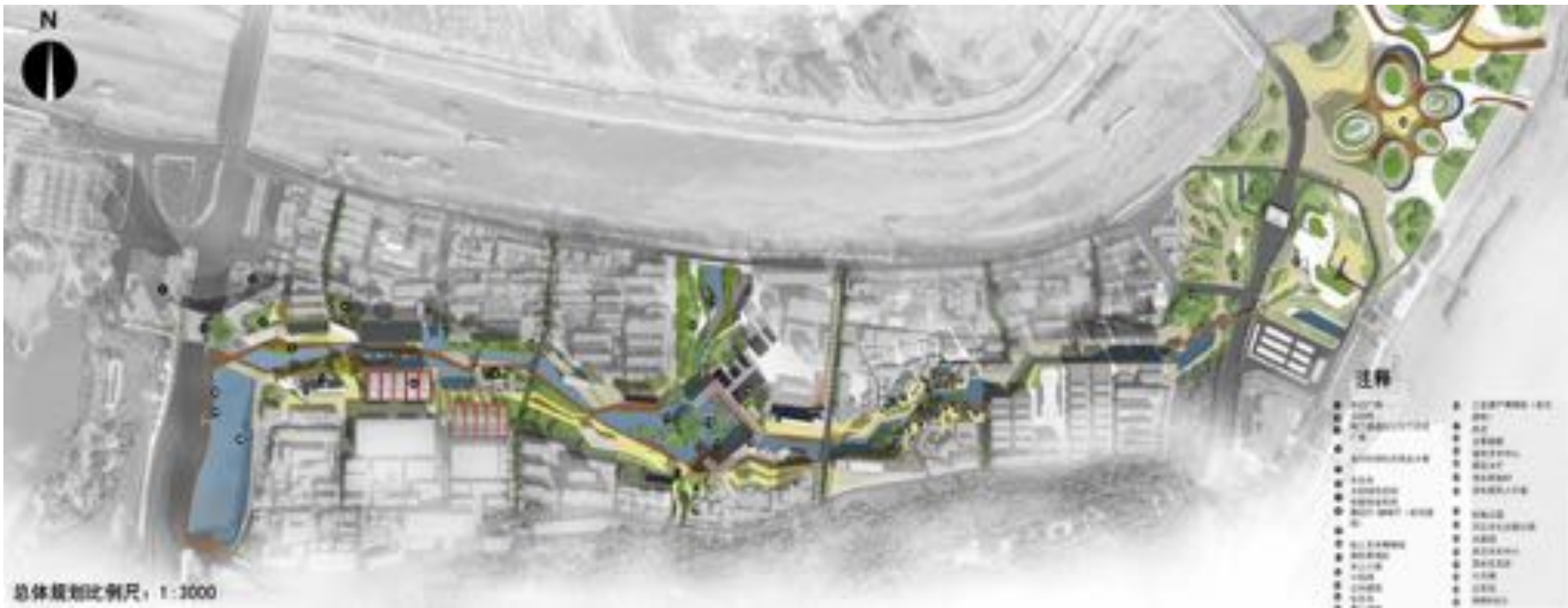

02 武汉野心 | Wuhan Wild Heart



02 武汉野心 | Wuhan Wild Heart



Natural Cooling Units

Since Wuhan is one of the hottest cities in China, people need to have a cool rest while going on a trip. We set up a series of places on the mountain for people to escape heatwave during summer time. The reason we choose to locate our shading units on the mountain is that the temperature is lower compared to the bottom, and also Guashan mountain is close to many famous cultural sites so that residents and tourists can get to the natural cooling places easily.



The Maze:

Using wood material and steel to build a maze for children and young people to play games and wander.



Industrial Entertaining Units

Our site is related to Hanyang steel plant, therefore, there are some industrial relics located among residential buildings. So we're going to build up entertaining units on the base of those relics using old metal materials and structural steel frames.



Roller Game:

This game is using rollers arranged in lines for children to touch, move and change the composition of numbers and signals on the rollers.

02 武汉野心 | Wuhan Wild Heart



02 武汉野心 | Wuhan Wild Heart



03 龟山创意工业园 | Turtle Mountain Creative Industry Park

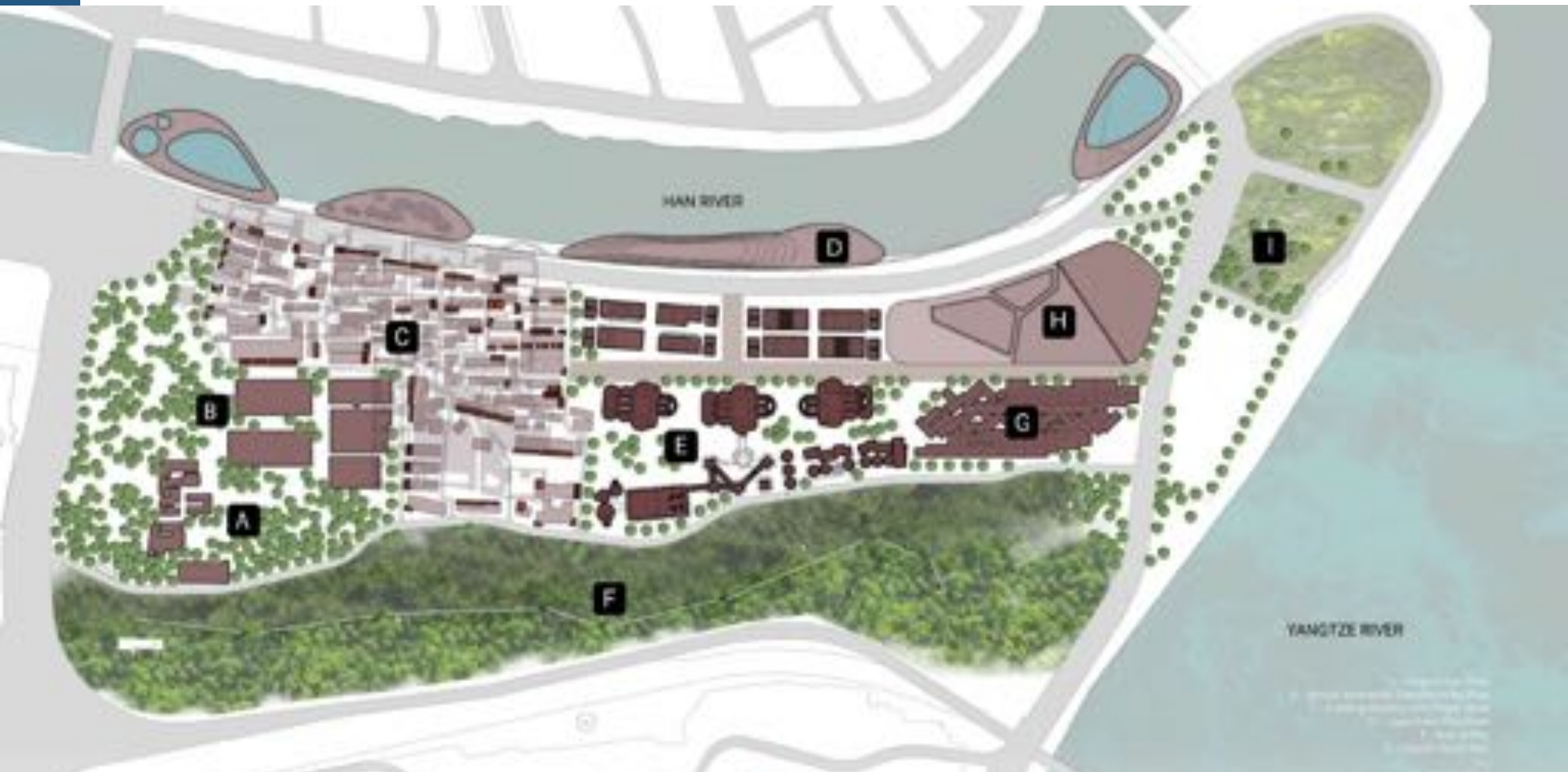

03 龟山创意工业园 | Turtle Mountain Creative Industry Park

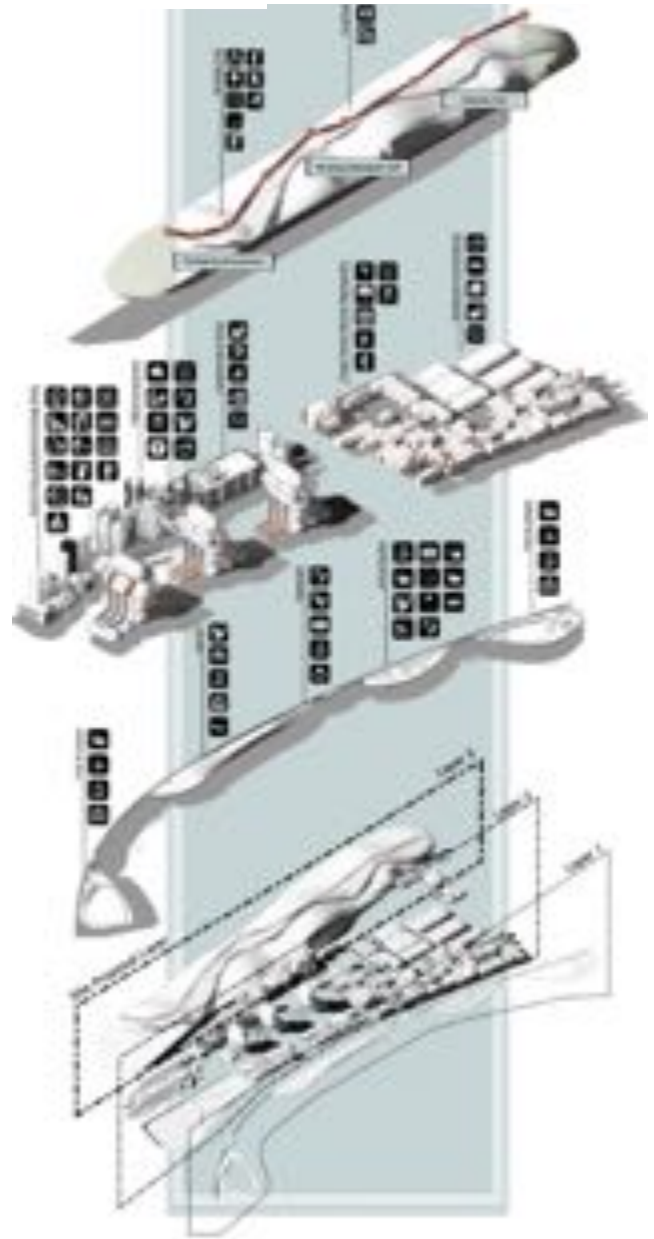

03 龟山创意工业园 | Turtle Mountain Creative Industry Park



滨水区
waterfront layer

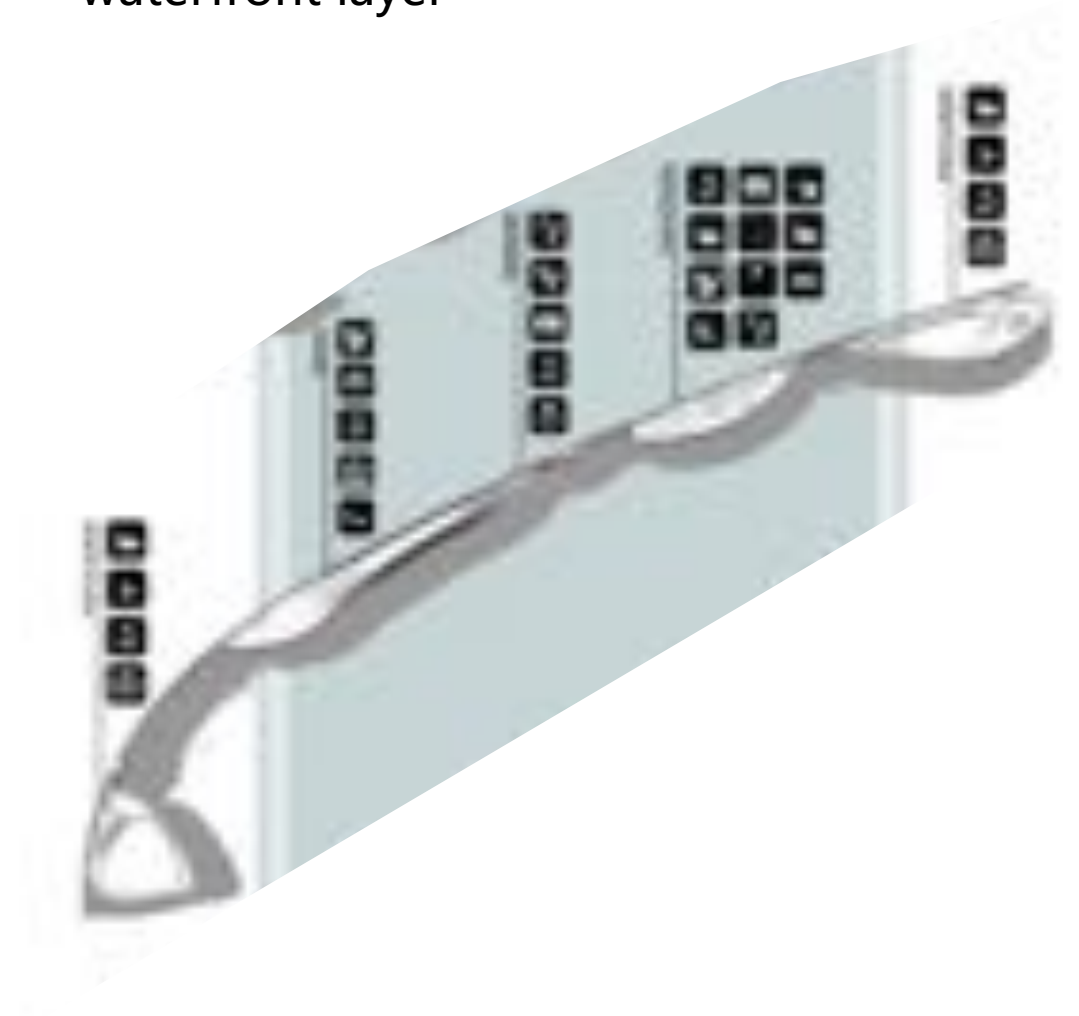

03 龟山创意工业园 | Turtle Mountain Creative Industry Park



陆地区
land layer

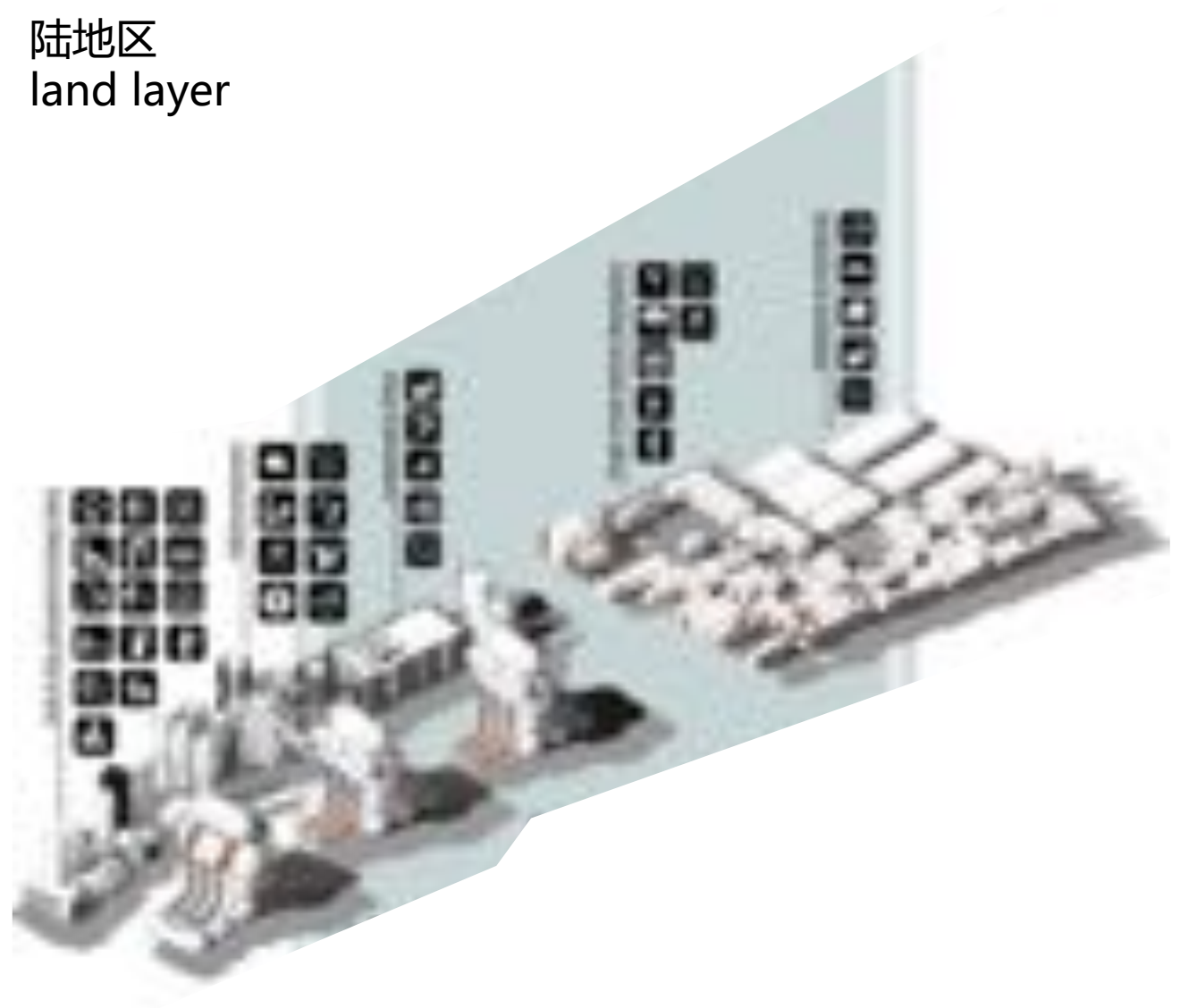

03 龟山创意工业园 | Turtle Mountain Creative Industry Park

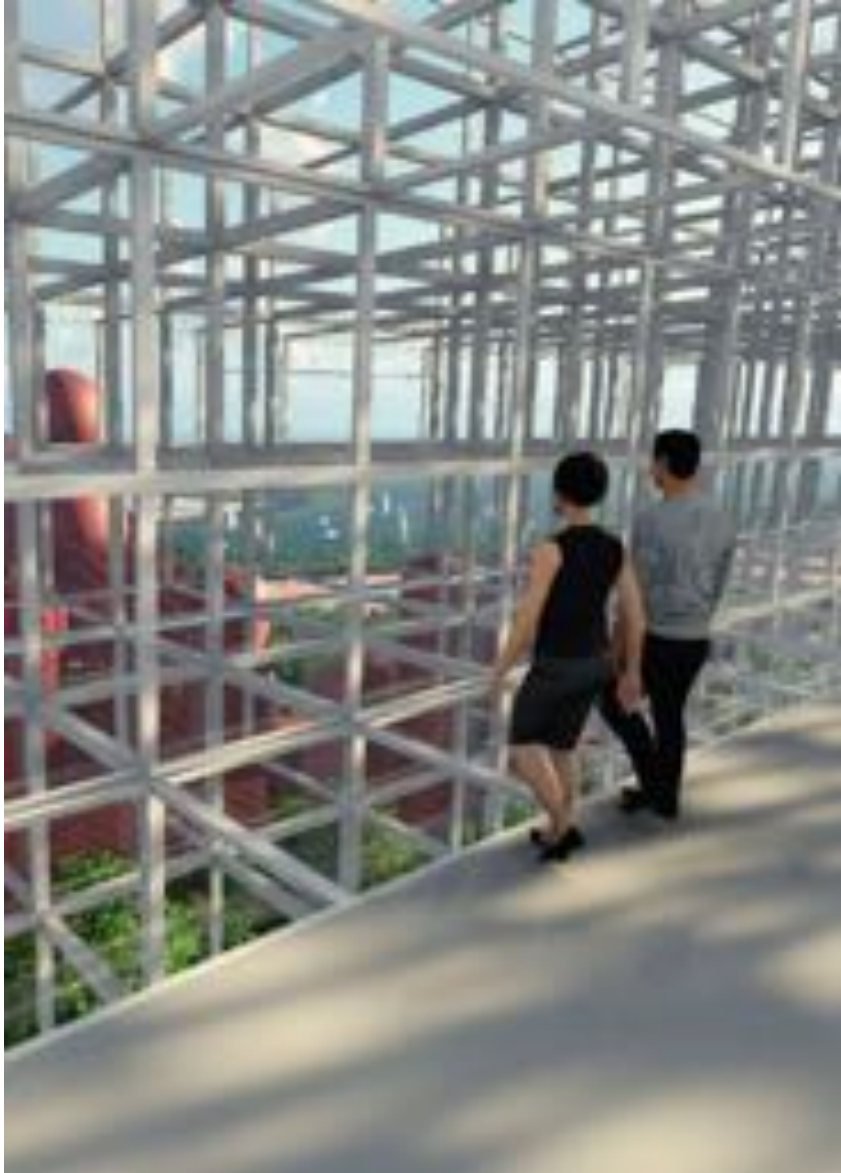

山地
mountain layer

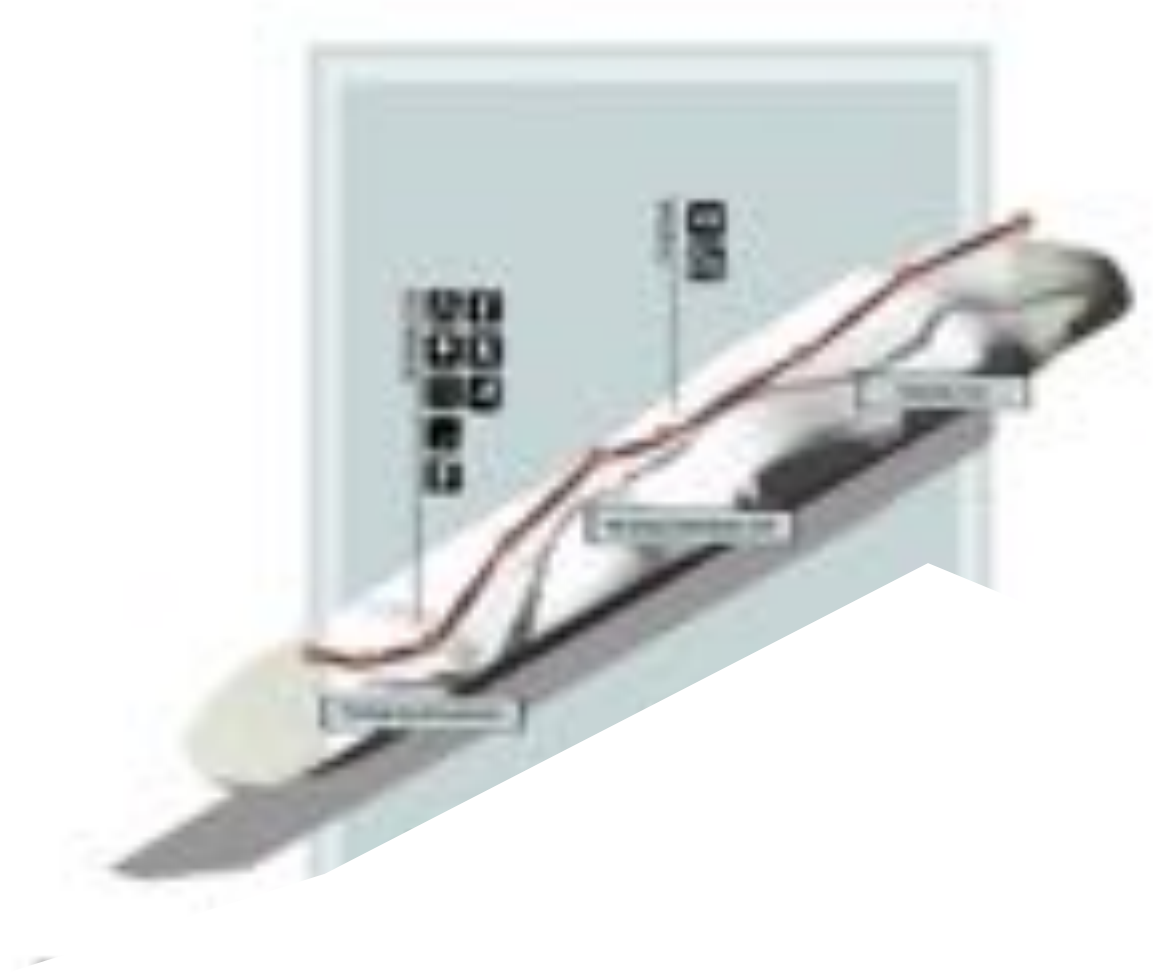

城市设计竞赛 | Urban Design Student Competition Proposal

关注重点方面：

需明确规划价值评判和目标体系，重点考虑**便捷可达**、**生态滨水**、**历史遗存**、**功能定位**等方面。

Convenient and accessible public space

便捷及可达的公共空间

Ecological Waterfront Places

生态滨水公共空间

Historical Remains and Public Space

历史遗存与公共空间

Public Space with Complex Functions

功能复合的城市中心区公共空间



Convenient and accessible public space 便捷及可达的公共空间

/01

- 优化区域交通 | Optimize Regional Transportation
- 协调内部交通 | Coordinate Internal Traffic

01 优化区域交通 | Optimize Regional Transportation

50-Co-Existence City

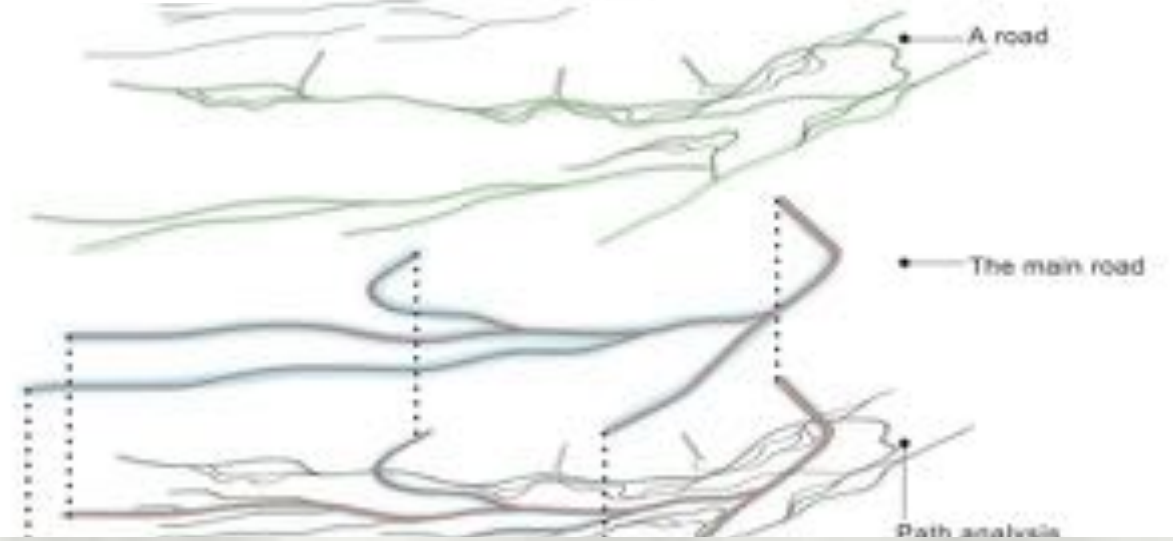





02 协调内部交通 | Coordinate Internal Traffic

143-Symbiosis With Natural And Cultural Context







Ecological Waterfront Public Places 生态滨水公共空间

/02

- 海绵景观设计 | Sponge Landscape Design
- 滨水活力轴线 | Waterfront Dynamic Axis
- 三镇未来地标 | Future Landmarks of Wuhan

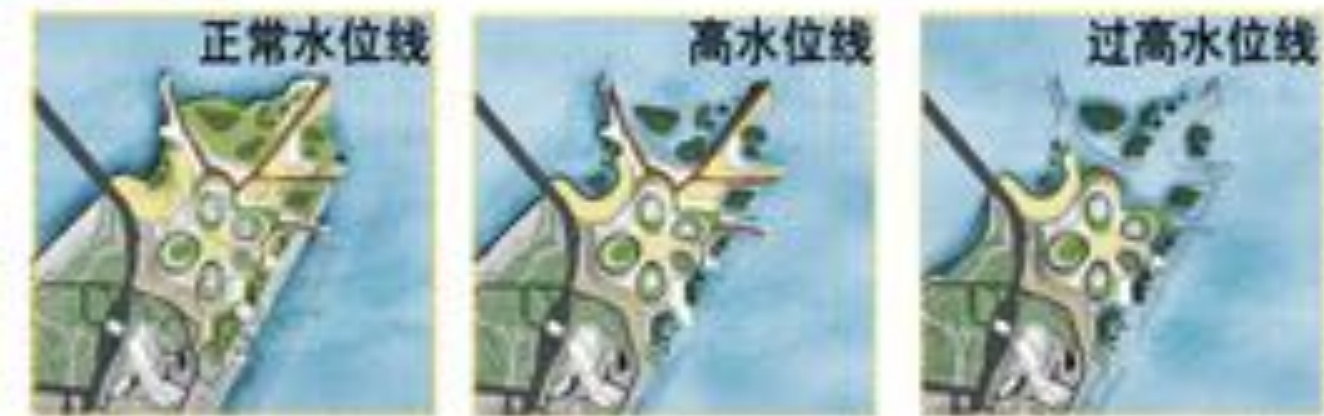
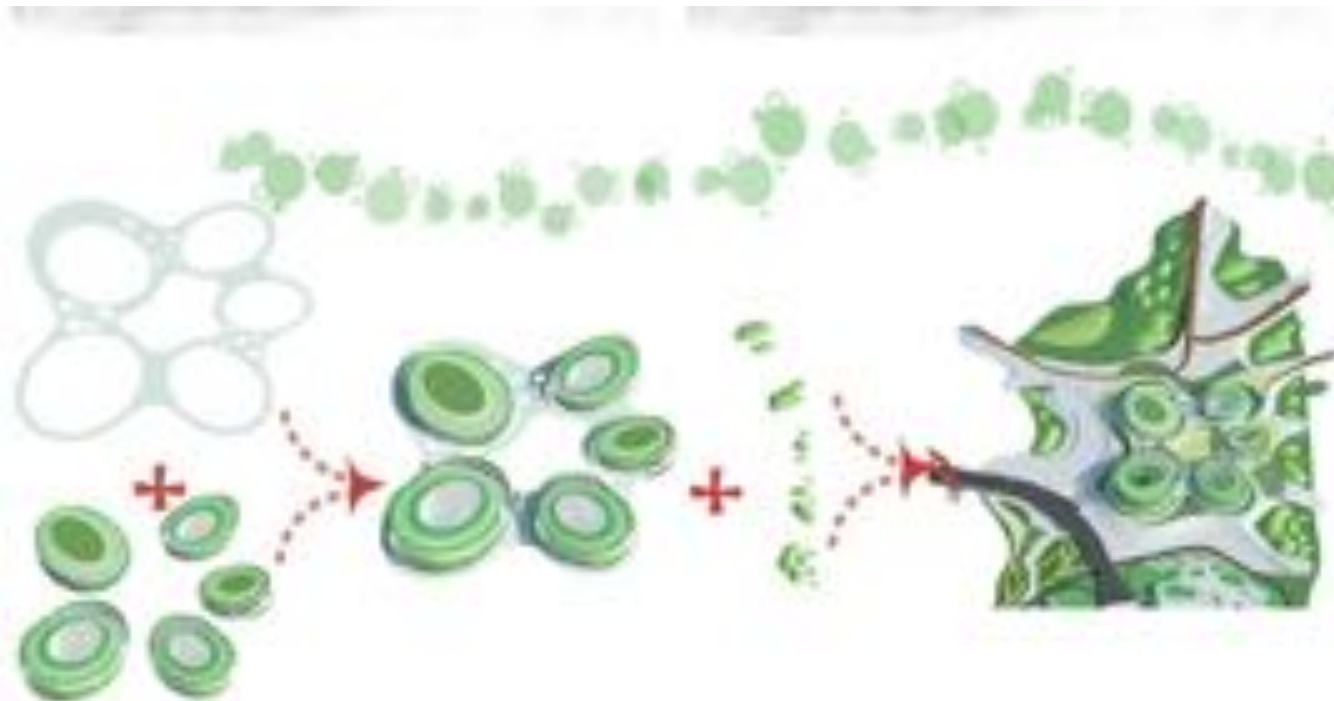

生态系统

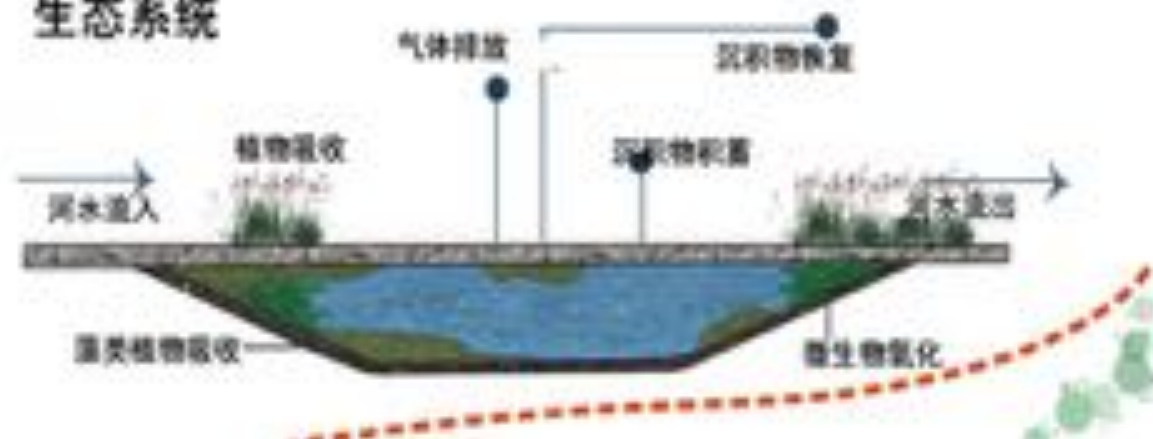



02 滨水活力轴线 | Waterfront Dynamic Axis

157-Fluidity and Symbio



■ 活动公园透视图











Historical Remains and Public Space 历史遗存与公共空间

/03

- 传统文化继承与创新 | inheritance and innovation of culture
- 工业遗产的利用 | the utilization of industrial heritage

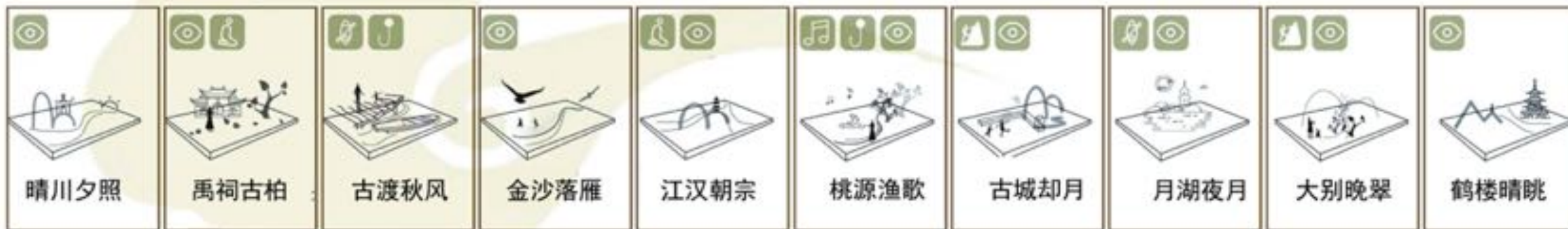







自然亲近装置
由于武汉是中国最热的城市之一，人们在旅行途中需要凉爽的休息。我们在山上设置了一系列凉爽供人们在夏日解暑纳凉。我们之前以在山上设置凉亭是因为山上的温度要比山下要低，而且青山与许多著名文化景点很近，居民和游客可轻松地到达自然凉亭点。



工业展示装置
我们的场地与汉阳铁厂有关。该点在许多居民楼中都有工业遗迹物。因此，我们打算用旧金属材料构建构筑物在原有工业遗迹物基础上搭建新体设备。



木质
用木材和金属材料搭建一个装置。供儿童和年轻人玩耍和健身。



金属游戏
将废旧排式一条路，供儿童游戏。移动和改变装置上的数字和符号组合。



作基地
我们在建造核心工具的同时模仿这些工厂设施和结构的形状与材料



棉纺织设备



棉纺织厂



下凉亭
人们可沿着坡道登上凉亭凉爽的凉亭休息。呼吸新鲜空气，观赏美景。

老照片展览
我们设置了一些著名的老照片，来展示 20 世纪辉煌的工业时代。人们可穿行于这而凉亭之间。



圆柱体空间
这些圆柱体形状的空间就像工厂的楼一样。儿童可爬进进去，发出响声，互相交流。



爬光轨道和攀爬
这些圆柱体形状的空间就像工厂的楼一样。儿童可爬进进去，发出响声，互相交流。

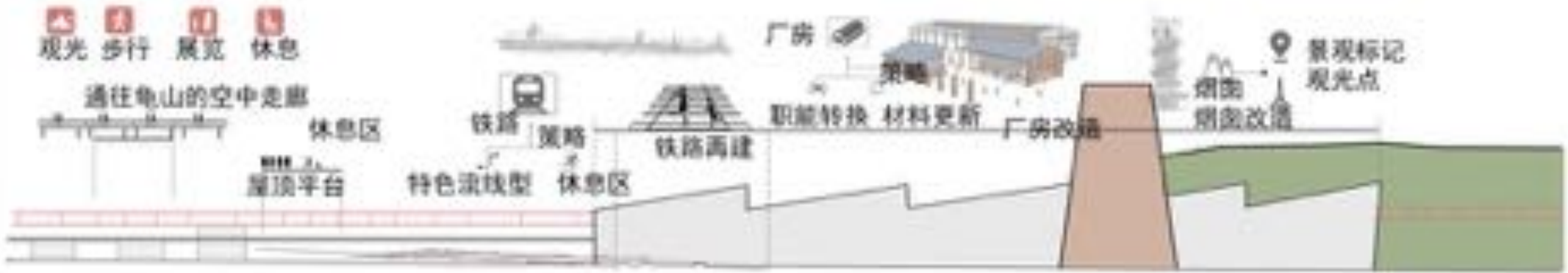



Public Space with Complex Functions 功能复合的城市中心区公共空间

/04

■ 活力的城市中心区域 | vibrant urban central area

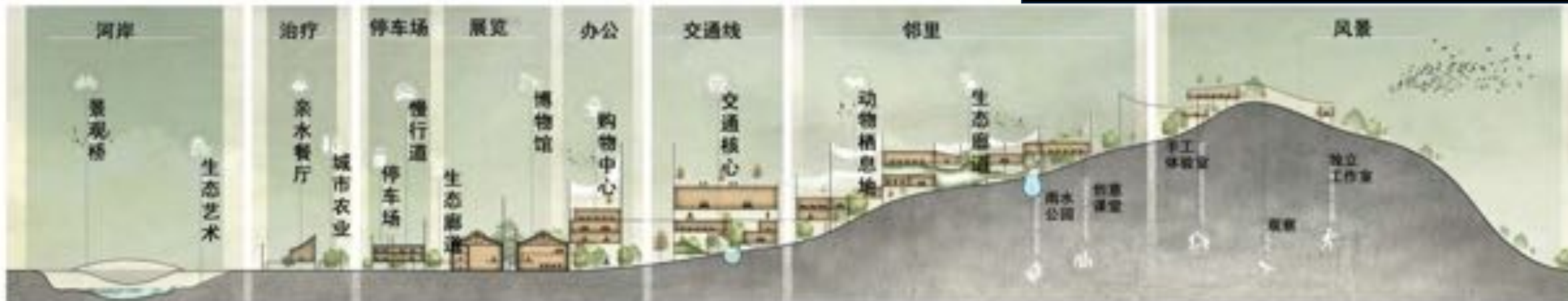

01 活力的城市中心区域 | vibrant urban central area 120-Urban Heritage and Transformation



01 活力的城市中心区域 | vibrant urban central area

157-Fluidity and Symbio

■ Design Details

■ Function of the Central Avenue



The perspective through the site, including the main function blocks in green, is divided into 4 themed corridors, namely Industry Culture Corridor, Creative Culture Corridor, Landscape Culture Corridor, defining the role value of the site.

■ Design & Art Festival



Series of areas/features relating to design, art, ecological infrastructure and new ecological technology will be built throughout the park, which will attract visitors from the

■ Perspective

■ Greeting Impression Mirror Water Plaza



■ Mirror Lake & Boutique Resort



An aerial photograph of Seoul, South Korea, showing the N Seoul Tower on a hill in the background, a large river with several bridges, and a dense urban landscape with many buildings. The text "THANK YOU" is overlaid in the center in a large, white, sans-serif font.

THANK YOU