

INSTALLATION INSTRUCTIONS

Sirius IV LED High/Low Bay

CONTENTS

How to order the Sirius IV	1	How to fit Sensor	3
Dimensions and Weight	2	Remote control	3
How to fit Suspension Mounting	2	Specification	4
How to fit Ceiling Mount	2	Important warranty information	4

WHAT'S IN THE BOX

1 x Sirius IV
1 x Eye loop hook

KEY FEATURES

Colour Temp: 5000K

CRI: >70

Working temperature: -30°C to 50°C*

Standards: IP65, IK08

HOW TO ORDER

EL80SFLB4	80W Sirius IV Low Bay (16,000lm) 90° Beam Angle
EL80SHB460	80W Sirius IV High Bay (16,000lm) 60° Beam Angle
EL110SFLB4	110W Sirius IV Low Bay (22,000lm) 90° Beam Angle
EL110SHB460	110W Sirius IV High Bay (22,000lm) 60° Beam Angle
EL150SFLB4	150W Sirius IV Low Bay (30,000lm) 90° Beam Angle
EL150SHB460	150W Sirius IV High Bay (30,000lm) 60° Beam Angle

When ordering, please specify the product variation you are interested in by adding the following suffixes to the product's code.

E: Emergency (*Note working temperature is 5°C to 35°C).

F: Emergency Self-Test (*Note working temperature is 5°C to 35°C).

Accessories

ELSV4N: Plug in Microwave Dimmable sensor

ELSV4P: Plug in PIR Dimmable sensor

ELSV4R: Remote to program the MW and PIR sensors (Note this is required)

SPS2BV3: Mounting bracket

WARNING AND WARRANTY EXCLUSIONS

It is recommended that luminaires are installed by a qualified Professional and the installation complies with the current IEE wiring regulations. Standard terms and conditions apply see website for full details.

- This luminaire is for professional use only and not to be used in a domestic environment.
- Any broken or damaged parts should be reported to the retailer as soon as possible before installation.
- Novah will not accept responsibility for claims arising from sub-standard installation, which will void the warranty.
- The external cable flex is fixed and should not be replaced. If the cable is damaged the luminaire will fail.
- Terminal block/connectors are not included. Installation may require advice from a qualified person.
- CAUTION. Do not open the luminaire for risk of electric shock and invalidating the warranty.
- The light source of this luminaire is not replaceable by the end user.
- It may be necessary to upgrade your RCD/MCBs to allow for increased inrush current.
- Take note of the ambient/working temperature.
- Ensure that you have the tools and accessories required to complete the installation correctly: Isolate the power before starting installation.
- At the top of the unit on the round power supply is a square rubber gasket. Removal of this voids the product warranty so please do not remove it.
- DO NOT LOOK DIRECTLY AT THE LUMINAIRE WHEN TURNED ON. These are powerful luminaires and can cause discomfort and potential damage to the eye if done so.

DIMENSIONS AND WEIGHT

EL80/EL110 NETT WEIGHT: 2.0Kg

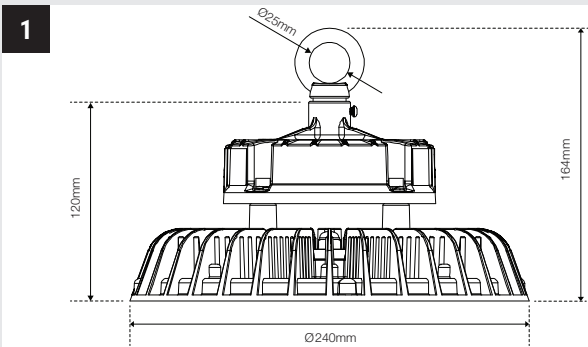

EL150 NETT WEIGHT: 3.0Kg

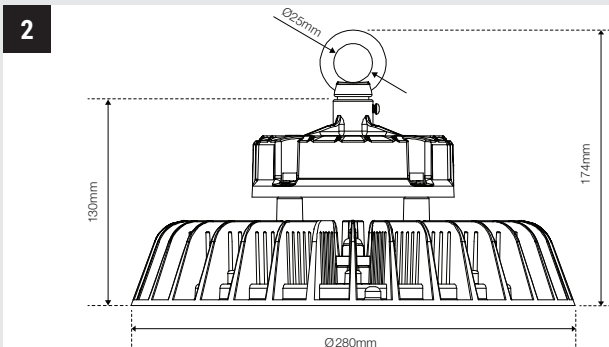

HOW TO FIT SUSPENSION MOUNT

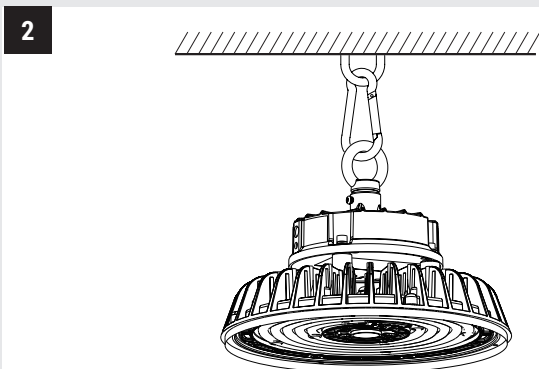
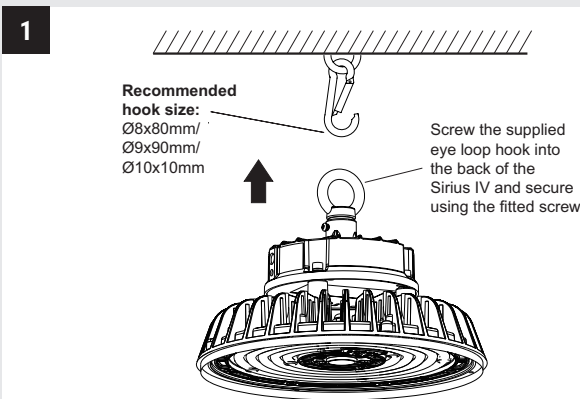

HOW TO FIT CEILING MOUNT (CODE: SPS2BV3)

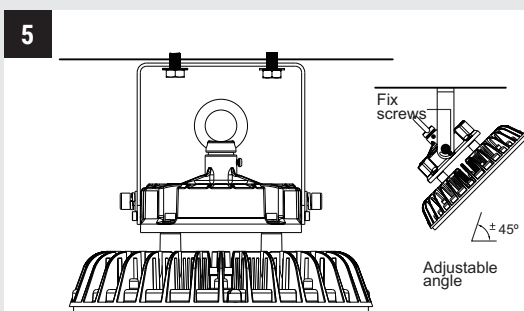
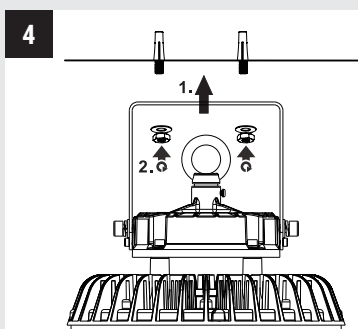
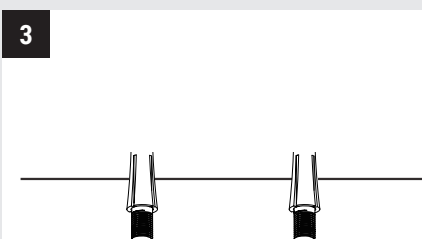
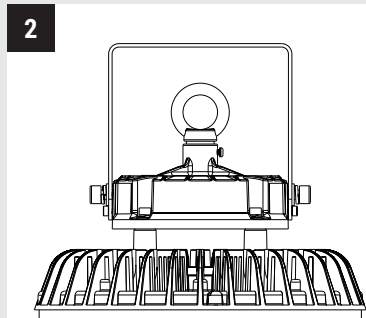
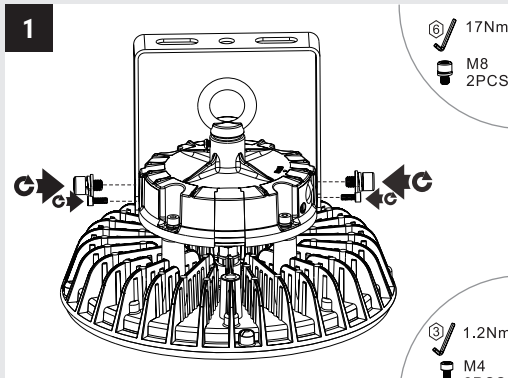
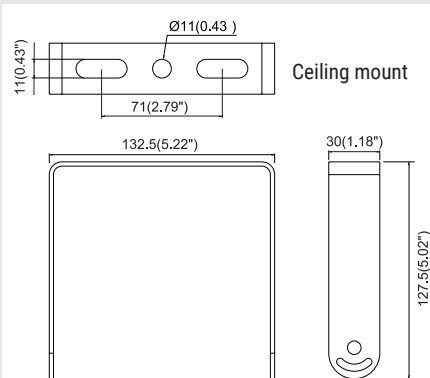

HOW TO FIT SENSOR (MICROWAVE: ELSV4N OR PIR: ELSV4P)

EL80/EL110 NETT WEIGHT: 2.0Kg

EL150 NETT WEIGHT: 3.0Kg

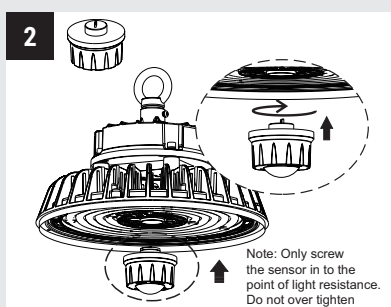
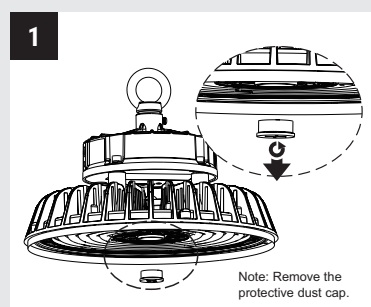

	Microwave Motion Sensor	PIR Sensor
Default Setting	Detection Area: 100% Hold Time: 3min Daylight Threshold: Disable Stand-by DIM Level: 50% Stand-by Period: 5min	
Mounting Height	Max 15m/49ft	Max 12m/39.37ft
Detection Range	Radius 3-7m/9.84-22.96ft	Radius 3-6m/9.84-19.68ft

REMOTE CONTROL: SCREEN DISPLAY, MEMORY AND APPLY FUNCTION, OPTIONAL SCENES

Model: ELSV4R

Briefing of button functions

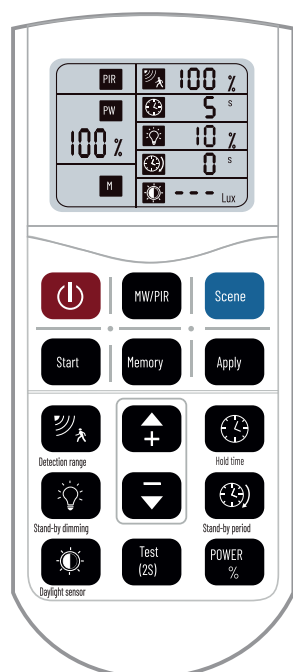

Buttons	Function	Performance
	ON/OFF	Turn sensor ON or OFF
	MW/PIR	Exchange from Microwave detection to PIR detection, for future use
	Reset	Press to start detection programming; before pressing any other buttons, the screen shows default programming (Detection Area 100%, Holdtime 5S, Daylight Disable, Standby Dimming 10%, Standby Period 0S)
	Start	Press before you try to memorize program into the remote. After pressing, S on the screen will blink and keeping blinking while making the program
	Memory	Press after programming, the blinking S will become a solid M, this means the program has been correctly memorized
	Apply	Press to deliver the pre-set program to the specific sensors; every press will make the whole screen blink gently
	Detection area	Also known as "sensitivity", 100% means the highest sensitivity and longest distance. Press, specific icon on the screen will blink and press the + - buttons to adjust
	Hold time	The period that the light will stay illuminated 100% after no motion is detected. Press, the specific icon on the screen will blink and press the + - buttons to adjust
	Daylight threshold	The pre-set lux level to compare with ambient brightness when motion is detected. Press, specific icon on the screen will blink and press the + - buttons to adjust
	Standby period	The period after holdtime, during which the light keeps standby dimming level. Press, specific icon on the screen will blink and press the + - buttons to adjust
	Standby dimming level	After holdtime, the light will dim from 100% to optional standby dimming levels. Press, specific icon on the screen will blink and press the + - buttons to adjust
	UP	The main functional buttons to adjust the factors to required level
	DOWN	
	POWER	Support manual change dimming output in detection mode. Press, specific icon on the screen will blink and press the + - buttons to adjust
	Test mode	Supports checking if the sensor works correctly with a short 2S holdtime. Press and the holdtime will change to 2S and it can't be memorized

How to program the presence Microwave (MW) or PIR Sensor (FOR dimming use, see overleaf)

- Press Scene on the remote.
- Select MW/PIR to which sensor you have (M or P will appear on the screen).
- Press Start and the S will blink on the remote control.
- Choose each of the functional buttons and press + or - to adjust. The setting will be displayed on the remote:
 - Power % - Used to adjust the brightness when presence is detected (Recommended 100%).
 - Detection Range - Used to set the sensitivity of the sensor (100%, 75%, 50% or 25%).
 - Hold Time - How long the luminaire will stay on before going to its next program (5S, 30Seconds, 1, 3, 5, 10, 20 or 30 Minutes).
 - Standby dimming level - How bright the unit will be when no presence is detected (10, 20, 30 or 50%).

- Standby Period - How long the unit will stay on in standby dimming level (0S (note this will deactivate the standby level and turn the unit off after the hold time), 10s, 30seconds, 1, 5, 10, 30, 60, - - (this is permanently)).
 - Daylight sensor - This is a photocell feature and can be used to set at what point in darkness the lights will turn on/off (Note we advise not to use this as different luminaire detect different levels of brightness which will result in some being on and others not).
- Press Memory (this will store the program in the remote).
 - Press Apply (this will send the program to the Luminaire).

You can now stand under each luminaire, point the remote in direction and simply press apply to send the program to each one. The unit will flash once to indicate that it has received the program.

How to adjust the brightness of the operating luminaire permanently

1. Point the Remote directly at the sensor and press the following buttons:
2. Press ON/OFF to turn off the light.
3. While off and still pointing at the luminaire use the up and down arrows to set the desired brightness (Note it is advised not to set the unit below 50%).
4. Press On/Off button and the luminaire will turn off and back on to indicate that the brightness has been permanently set.
5. The luminaire will remember this setting even when turned off by a switch on the wall.

The process must be repeated to each luminaire you wish to operate like this.

SPECIFICATION

Power Supply information

Wattage	Input Voltage	Surge inrush	Surge Protection	Power Factor	Weight	Dimensions
80W	220-240Vac 50/60Hz	80A Cold Start (350uS)	CM: 6kV DM: 6kV	0.95	2.0kg	240Ø x 164mm
110W					3.0kg	280Ø x 174mm
150W						

Driver tested at 240Vac 25°C Ta. NOTE: It may be necessary to upgrade your RCD/MCB type to allow for increased inrush current.

How to wire

Standard version connection

200-240V~50/60Hz / Class I ⚡

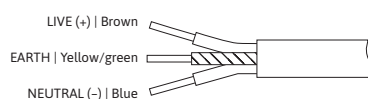

Emergency version connection

200-240V~50/60Hz / Class I ⚡

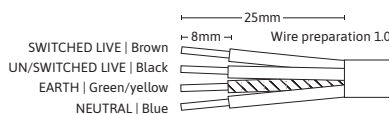

All units come with 1.5m prewired 3 core mains flex, Emergency versions are fitted with 4 core mains flex.

Terminal block must comply to EN 60998-2-1 or EN 60998-2-2

PRODUCT VARIANTS

"E" and "F" Emergency versions

All Emergency options are 4W giving a maintained output of 800LM.

E = Standard 3 hour emergency.

F = Self-Test 3 Hour emergency DALI (compatible).

Please allow for 24 hours for the batteries to fully charge.

IMPORTANT WARRANTY INFORMATION

This product is supported by 5-year standard warranty.

Emergency versions have a 5-year warranty on the control gear and the batteries have a 2-year warranty.

Terms and conditions apply see website for more details.

