

# Square Shower Valve Kit

Product Code: SQKIT

**Construction**  
**Finishes**  
**Product Type**  
**Water Pressure**  
**Plumbing Systems**

**Standards**  
**Certification**  
**Cartridge**  
**Fitting**  
**Diverter**  
**Check valve**  
**Packaging**  
**Guarantee**  
**Additional Information**

Brass Body (CuZn38Pb18)  
Chrome plated to BS EN 248  
Contemporary  
Min. 0.5 bar, Max. 6.0 bar  
Suitable for all plumbing systems, preferably balanced. Min. supply pressure differential requirement is 5:1  
Complies with BSEN 1111  
Manufactured to comply with WRAS, TMV2  
Thermostatic  
Easy Fit (15mm compression connection)  
Ceramic disc  
0.5-10 gpm  
64 x 31.5 x 39.5cm / carton (10 boxes / carton)  
10 years against manufacturing faults (excluding serviceable parts).  
1. Temperature: Pre-set 38°C, with push button override to 48°C.  
2. Automatic shut off in the event of hot or cold water supply failure.  
3. Shower handset : Chrome , single mode, ABS  
5. Shower hose : Chrome, stainless steel , double interlock, 1.5m

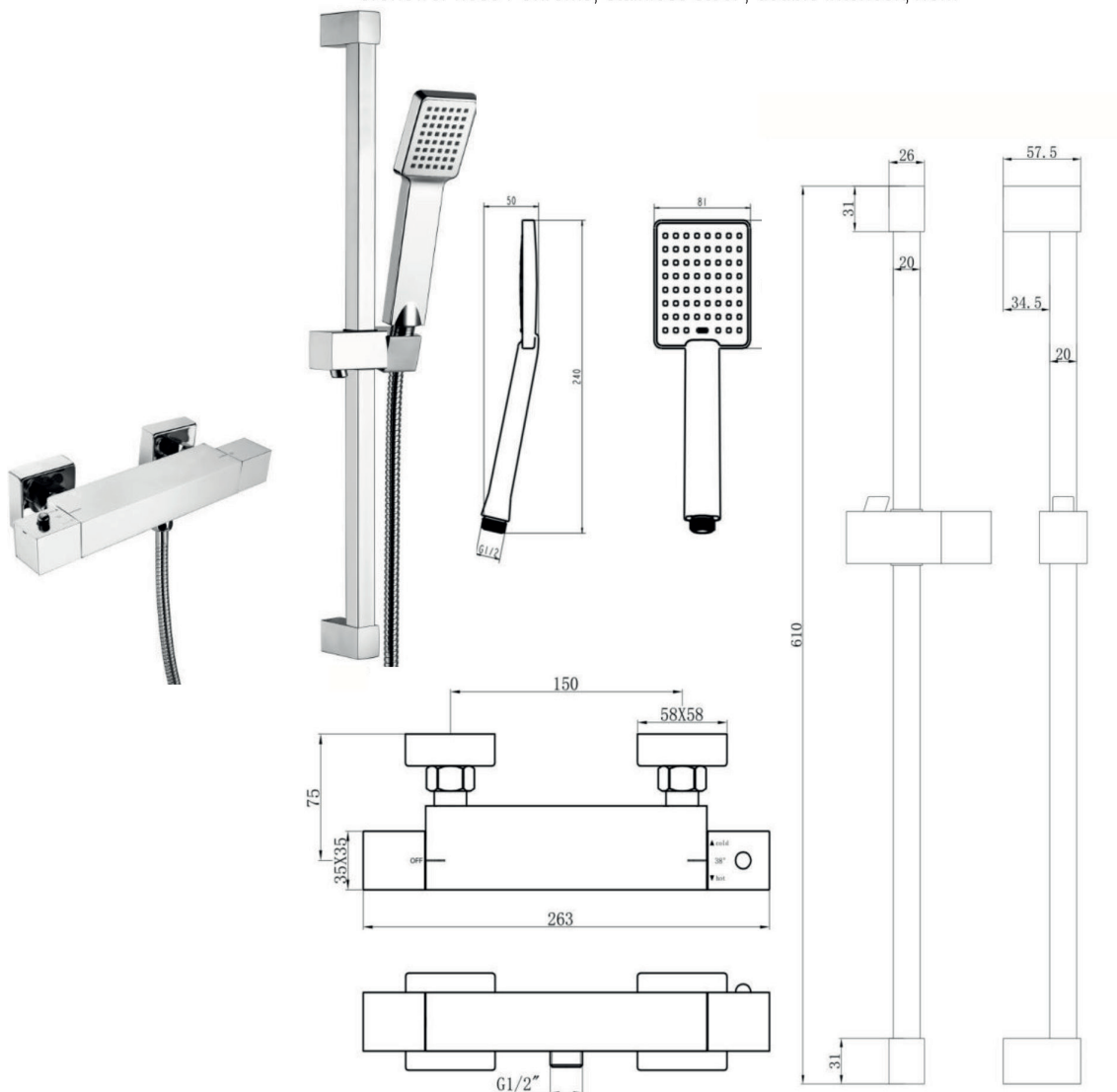

**Flow Rates** (Litres per minut.,

System Pressure	0.1 Bar	0.2 Bar	0.3 Bar	0.5 Bar	1.0 Bar	1.5 Bar	2.0 Bar	3.0 Bar	4.0 Bar	5.0 Bar
SQKIT	6.0	7.0	-	8.5	12.0	14.0	18.5	22.0	-	-

The information contained on this page was correct at date of issue. Fitting dimensions are provided as a guide only. Some variation may occur due to manufacturing tolerances. We pursue a policy of continuing improvement in design and performance of our products and so reserve the right to change specifications without prior notice.

# Square Shower Valve Kit

Product Code: SQKIT

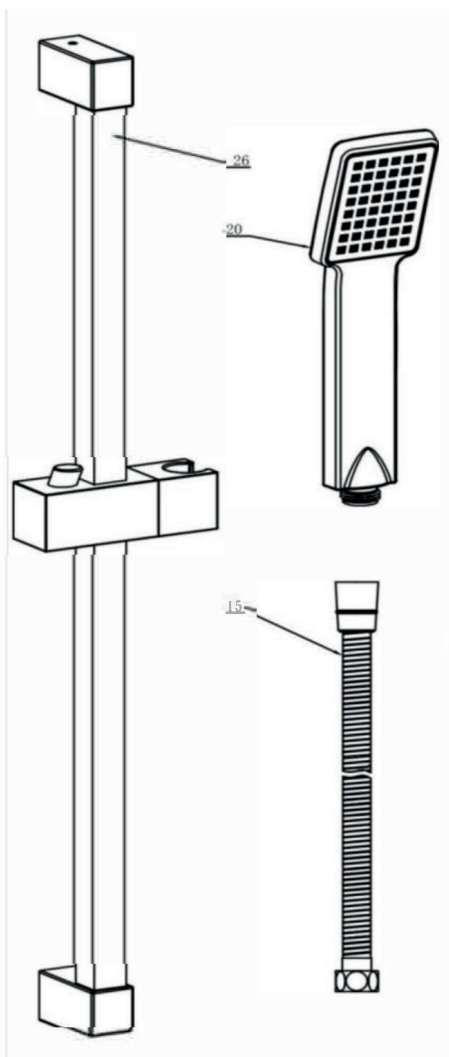

NO.	DESCRIPTION	QTY
1	THERMOSTATIC VALVE BODY	1
2	QUARTER-TURN CARTRIDGE	1
3	WASHER	2
4	ABS	1
5	SAFETY BUTTON	1
6	DIVERTOR HANDLE	2
7	SCREW	2
8	THERMOSTATIC CARTRIDGE	1
9	MOUNTING NUT	1
10	THERMOSTATIC HANDLE	1
11	HPb59-1	2
12	CHECK VALVE	2
13	CONNECTOR	2
14	O RING	3
15	1.5M SHOWER HOSE	1
16	G1/2" CONNECTOR	1
17	SQUARE WALL COVERS	2
18	FILTER WASHER	2
19	OFF-SET CONNECTOR	2
20	SQUARE HANDSHOWER	1
21	WASHER	2
22	COVER	1
23	SPRING	1
24	MOUNTING PART	1
25	COVER	1
26	SQUARE SLIDING RAIL	1

