

60,000 / 80,000 RPM FOR FASTER AUTOMATIC PRODUCTION

Our 800 Series operates 24/7 accelerating your production.

This patented motor increases airflow to match cutting load maintaining your rated speed in cut with micro tools.

Air Turbine Motors® are low friction direct drives with only 2 moving parts resulting in no heat and great reliability.



Patented Governor Control Maintains 60,000/80,000 RPM in Cut

Get 5 x faster production with this mini motor from Air Turbine Motors®

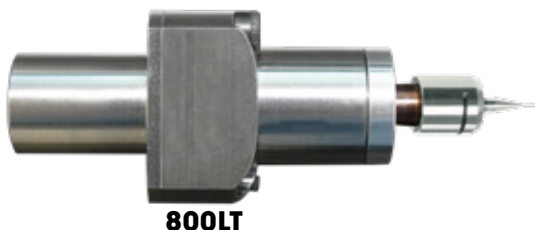

- ▶ No control system, no lubricator, no gears or high frequency brushes to burn up.
- ▶ No Heat. Direct Drive Reliability.
- ▶ Just connect 90 PSI, 6.2 Bar dry clean air supply and mill on any Swiss Automatic.

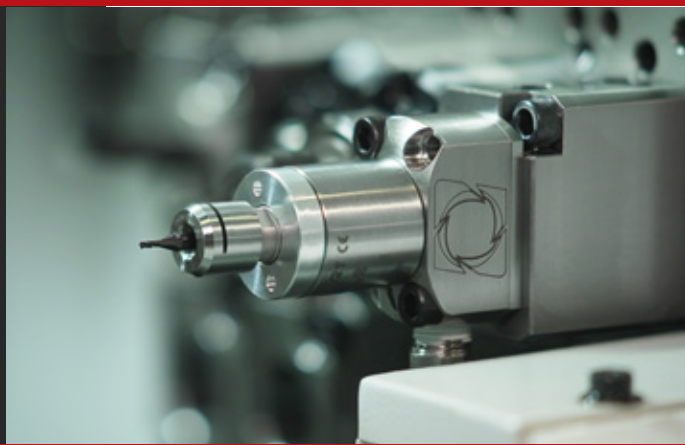

+1 561 994 0500 - +49-1716513614

View 40 Air Turbine Motors® at www.airturbinetools.com

ask@airturbinetools.com | +1 561 994 0500 | +49-1716513614 | www.airturbinetools.com

All specifications approximate. Patents issued and pending. © 2021 Air Turbine Technology, Inc. All rights reserved.

60,000 / 80,000 RPM FOR FASTER AUTOMATIC PRODUCTION

Our patented governor increases CFM/LS airflow under load so you keep constant speed in cut.

SPECIFICATIONS

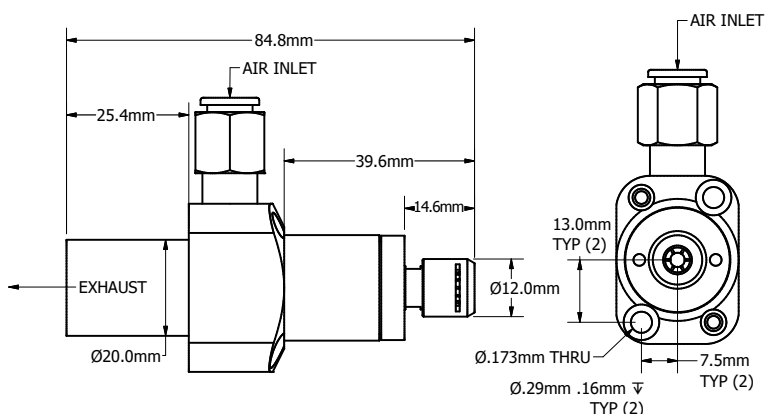

800LT

Ø19.05, 20, 22, 25mm OD Available

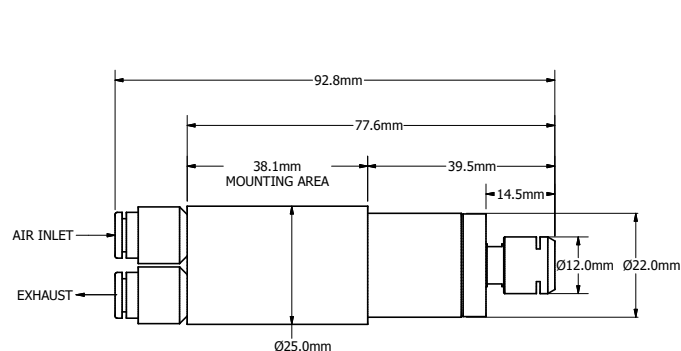

**800CYL
Ø25mm OD**

General Specifications	800LT + 800CYL
Governed Speed RPM	60,000/80,000
Power Rating hp (kW)	0.2 (0.15)
Inlet Air Pressure	90 PSI (6.2 Bar)
Air Consumption Idle cfm (l/s)	3.5
Air Consumption Working Flow cfm (l/s)	5
Sound Level	Less Than 78 dBA
Max Shank Capacity	ER 8 - 1/8" (3mm)
Motor Weight	5.6 oz (0.158 kg)

Standard Equipment
Combo filter regulator (p/n #30001), collet, wrenches, hose, fittings and carrying case.
ER 8 UP collet system (1/8" or 3mm collet standard - other sizes optional).
Oil free 90 psi / 6.2 bar clean, dry air supply required.
The 800 Series is for use with micro tools, and larger tools up to 0.8 mm / 1/32" with light cuts.

INSTALLATION

Secure the body of the motor in your gang tool or boring bar holder. Connect a dry clean 90PSI - 6.2 Bar air supply station using couplings, connectors and hoses at least 6 mm - 1/4" internal diameter. Install filter included on the air line to assure clean air. No control system, wiring or lubrication.



+1 561 994 0500 - +49-1716513614
View more Air Turbine Motors® at www.airturbinetools.com

ask@airturbinetools.com | +1 561 994 0500 | +49-1716513614 | www.airturbinetools.com

All specifications approximate. Patents issued and pending. © 2021 Air Turbine Technology, Inc. All rights reserved.