

Above Ground Storage Tanks - Vertical



From 2,500 to
30,000 Litres

High volume liquid storage for potable water or waste

Equally at home either as a WRAS-approved potable water tank or as a waste receiver, if you need large volume liquid storage then these **Vertical Storage Tanks** are the ideal solution for a wide range of applications.

Applications may include emergency back-up drinking water supply through to temporary water supply at festivals and/or the storage of toilet effluent until it can be disposed of at the treatment works...and much more.

Just as an idea, these tanks will harvest rainwater from factory roofs, store potable and non-potable water or store toilet waste and slurry!

Capacities range from 2,500 to 30,000 litres (500 to 6,600 gallons) but if that's not enough, you can also link these tanks together to create the volume you require.

There are so many different ways you can configure these tanks: please consult pages 2-3 for just some of the configurable options. If there's something else you'd like to add, which is not covered here, please call to discuss.

Technical Advantages

- Built-in lifting points (4)
- Flat base for stability
- Self-supporting roofs for added strength
- A wide range of accessories & options

Applications

- Bulk waste storage (e.g. portable toilet waste)
- Bulk water storage
- Back-up emergency drink water supply
- Food industry
- Temporary water supply for events and festivals
- Civil engineering projects without mains water
- Suitable for a wide range of liquid chemicals

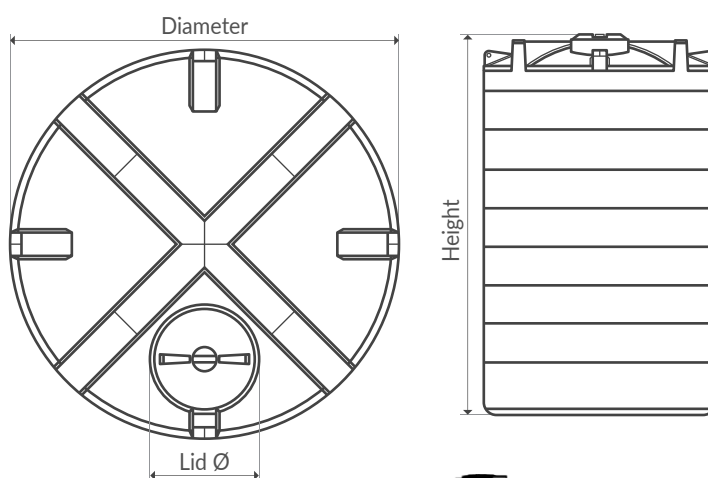

(10,000 Litre Tank depicted)

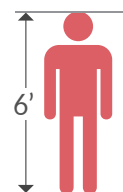

(30,000 Litre Tank depicted)

Sizes are approximate

PRODUCT GUARANTEE: 10 YEARS SUBJECT TO NORMAL WEAR, TEAR & USAGE CONDITIONS

Above Ground Storage Tanks - Vertical

**WRAS
APPROVED**

Tank Accessories & Options

01. Tank Draining



Drain and ball valve assemblies fitted to the base of the tank enable you (1) empty the contents via tanker vehicle, (2) connect the tank to pumping or process equipment or (3) link the tank to other tanks (eg. for bulk water storage).

02. Tank Filling



Tanks are filled from the top using "up and over" pipework and/or a ball cock valve. Typical fillings may be (1) mains-rising water, (2) pumped water from a tanker vehicle or (c) toilet waste from a macerating pump or tanker.

03. Tank Linking



To increase water storage or waste collection capacity, tanks can be linked together with 2" 3" or 4" pipework. Most applications use isolation ball valves for added flexibility: to rotate the use of individual tanks or to allow empty tanks to be flushed out or cleaned.

04. Liquid Levels

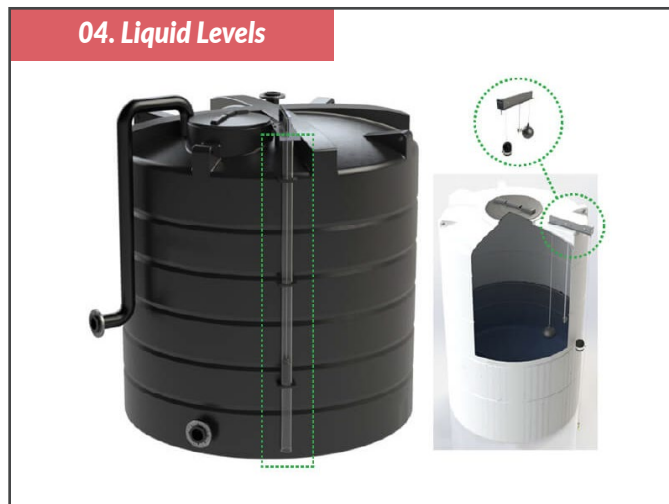

An externally-mounted, vertical "cat and mouse" gauge shows the level of liquid within the tank and is suitable whenever you need to be aware of low level (e.g. water, process chemicals) or high level (e.g. toilet effluent). This simple solution does not require power.

Above Ground Storage Tanks - Vertical

**WRAS
APPROVED**

Tank Accessories & Options (cont.)

05. Venting & Securing



When tanks are being filled or emptied, particularly at high flow rates, it is good practice to opt for a vent to allow the tank to “breathe.” On exposed sites we suggest fitting welded feet to allow the tank to be bolted down.

06. Bunded Tanks



Bunded holding tanks are a “tank within a tank” and are widely used in the construction, events and sanitation industries, as well as for domestic and commercial applications. Available up to 10,000 litres only.

07. Rainwater Harvesting



These tanks are ideal for harvesting rainwater from large area, pitched roofs. Harvested rainwater can be used for agricultural sprayers, wash down water, grey water systems for flushing toilets, for industrial washing and cooling...and much more.

08. Insulated Tanks



Insulated water tanks are used where temperature regulation is key and/or for the prevention of overheating or freezing of liquids. Tanks are sprayed with an insulated foam finish in 13mm or 25mm thickness. The plastic polymer is WRAS-approved for drinking water storage.

Technical Data



Volume (Litres)	Volume (Gallons)	Height (mm)	Diameter (mm)	Dry weight (KGs) / SG	Applications What Liquids?	SKU / Stock Code	Standard colour
2,500	511	1,800	1,400	60 (SG1)	Non-potable / rainwater	AGST-V-2500-NP	Black
				60 (SG1)	Potable water / WRAS	AGST-V-2500-P	
				80 (SG1.5)	Toilet waste / slurry	AGST-V-2500-SLURRY	
5,000	1,101	2,300	1,900	120 (SG1)	Non-potable / rainwater	AGST-V-5000-NP	Black
				120 (SG1)	Potable water / WRAS	AGST-V-5000-P	
				160 (SG1.5)	Toilet waste / slurry	AGST-V-5000-SLURRY	
10,000	2,203	2,500	2,400	190 (SG1)	Non-potable / rainwater	AGST-V-10000-NP	Black
				210 (SG1)	Potable water / WRAS	AGST-V-10000-P	
				280 (SG1.5)	Toilet waste / slurry	AGST-V-10000-SLURRY	
15,000	3,304	3,650	2,400	320 (SG1)	Non-potable / rainwater	AGST-V-15000-NP	Black
				320 (SG1)	Potable water / WRAS	AGST-V-15000-P	
				400 (SG1.5)	Toilet waste / slurry	AGST-V-15000-SLURRY	
20,000	4,405	3,600	2,850	420 (SG1)	Non-potable / rainwater	AGST-V-20000-NP	Black
				420 (SG1)	Potable water / WRAS	AGST-V-20000-P	
				540 (SG1.5)	Toilet waste / slurry	AGST-V-20000-SLURRY	
25,000	5,507	4,650	2,700	530 (SG1)	Non-potable / rainwater	AGST-V-25000-NP	Black
				530 (SG1)	Potable water / WRAS	AGST-V-25000-P	
				660 (SG1.5)	Toilet waste / slurry	AGST-V-25000-SLURRY	
30,000	6,608	3,650	3,450	600 (SG1)	Non-potable / rainwater	AGST-V-30000-NP	Black
				600 (SG1)	Potable water / WRAS	AGST-V-30000-P	
				720 (SG1.5)	Toilet waste / slurry	AGST-V-30000-SLURRY	

NOTES:

(1) Dimensions	Tank dimensions may vary by +/- 3% - tanks will expand and contract owing to temperature fluctuations.
(2) SG - Specific Gravity	Tanks are manufactured in grades (gauges) of plastic to suit the density / specific gravity of the liquid contents. Water has an SG of 1. Slurry / toilet waste has an SG closer to 1.5 for which heavier gauge material is required.
(3) Colours	Non-potable water (NP-suffixed) tanks are available in black as standard. Potable water (P-suffixed) and Toilet Waste (S-suffixed) tanks are available in black or natural as standard. In all cases, dark green or blue tanks are available at a price uplift of typically 10-15%. Longer lead-times may apply.
(4) Pricing	On account of raw material price volatility, prices are an indication only and can only be confirmed when quoting.
Delivery	Standard delivery is "kerbside" only and assumes - the customer will need to provide suitable offloading equipment. Although tanks are equipped with 4 x lifting eyes for empty lifting only, suitable straps / eyelets will be required. Timed, FORS and HIAB deliveries are available at extra cost. The driver is not qualified to advise on, or install the product. Prices are ex-works + delivery + VAT. On account of extreme raw material price volatility "slurry" tanks are POA only.

We reserve the right to amend the technical specification to improve the product without prior notification

PRODUCT WARRANTY:

**SUBJECT TO GENERAL WEAR, TEAR & USAGE CONDITIONS = 12 MONTHS WARRANTY AS STANDARD
 UPGRADE TO 10 YEAR WARRANTY BY RETURNING THE "EXTENDED WARRANTY CONDITIONS" WITHIN 21 DAYS OF SUPPLY**