

543 THIRD AVENUE

CORNER OF 3RD AVENUE & 36TH STREET | MURRAY HILL



EXCLUSIVE

AVAILABLE FOR LEASE OR SALE



RETAIL SPACE FOR LEASE



Virtual Rendering

543 THIRD AVENUE

CORNER OF 3RD AVENUE & 36TH STREET | MURRAY HILL

SIZE

Ground Floor approx. **8,400 SF**

Basement approx. **3,714 SF**

FRONTAGE 100 ft on Third Avenue

CEILING HEIGHT 10'

POSSESSION Immediate

SUMMARY

Be part of vibrant Murray Hill / Midtown South on a major artery accessible to public transit and the Queens Midtown tunnel.

- Prime corner high traffic location
- Spacious retail gem brimming with potential with 100 ft frontage on a major avenue

Local retailers: Murray Hill Market, D'Agostino Supermarket, Pookie & Sebastian, Shake Shack, Sarge's Delicatessen, Jackson Hole, Bare Burger, City MD, Starbucks

Local businesses: St. Vartan's Armenian Cathedral, Consulate General South Africa, Shelburne Hotel, McCann NY Advertising agency, The Marmara

Residential Buildings: Corinthian, House 39, Murray Hill Tower, American Copper Bldgs. Tudor City

Vicinity: NYU Medical Center, United Nations, Tisch Hospital, NYU Langone, Bideawee

OVERVIEW

- 19-story condo building (118 units) built in 1963
- The neighborhood is Murray Hill
- NE corner of East 36th Street and Third Avenue
- **100 feet** of retail exposure on Third Avenue
- **8,400 SF** (approx) on street level & **3,714 SF** (approx) on lower level
- Ceiling height: 10" (both levels)
- Conveyer belt (from Basement to Ground Floor)
- Wheelchair Accessible (restroom)
- Delivered vacant
- Can be divided

FLOOR PLAN

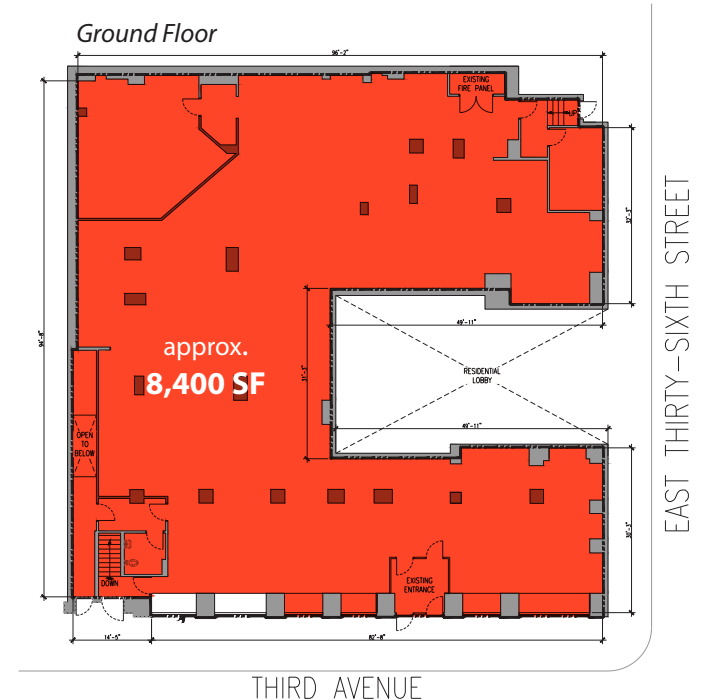
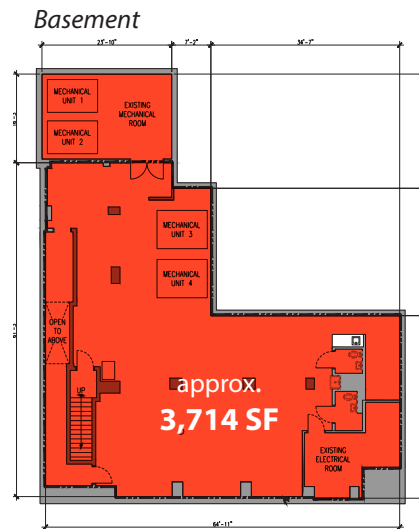

CONTACT OUR BROKER FOR MORE INFORMATION

CONRAD BRADFORD

CBradford@ksrny.com

917.403.0980